

LOC		DIST		REVISIONS			
P	LTR	DESCRIPTION	DATE	DN	APVD		
M1		REVISED PER ECO-08-009053	16APR08	DH	AS		
M2		REVISED PER ECO-09-020689	25AUG09	KK	AEG		

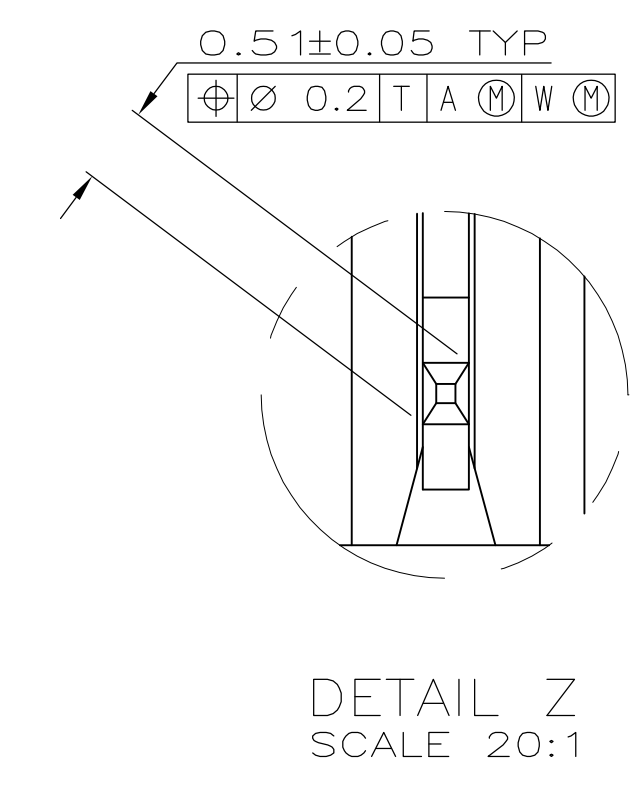
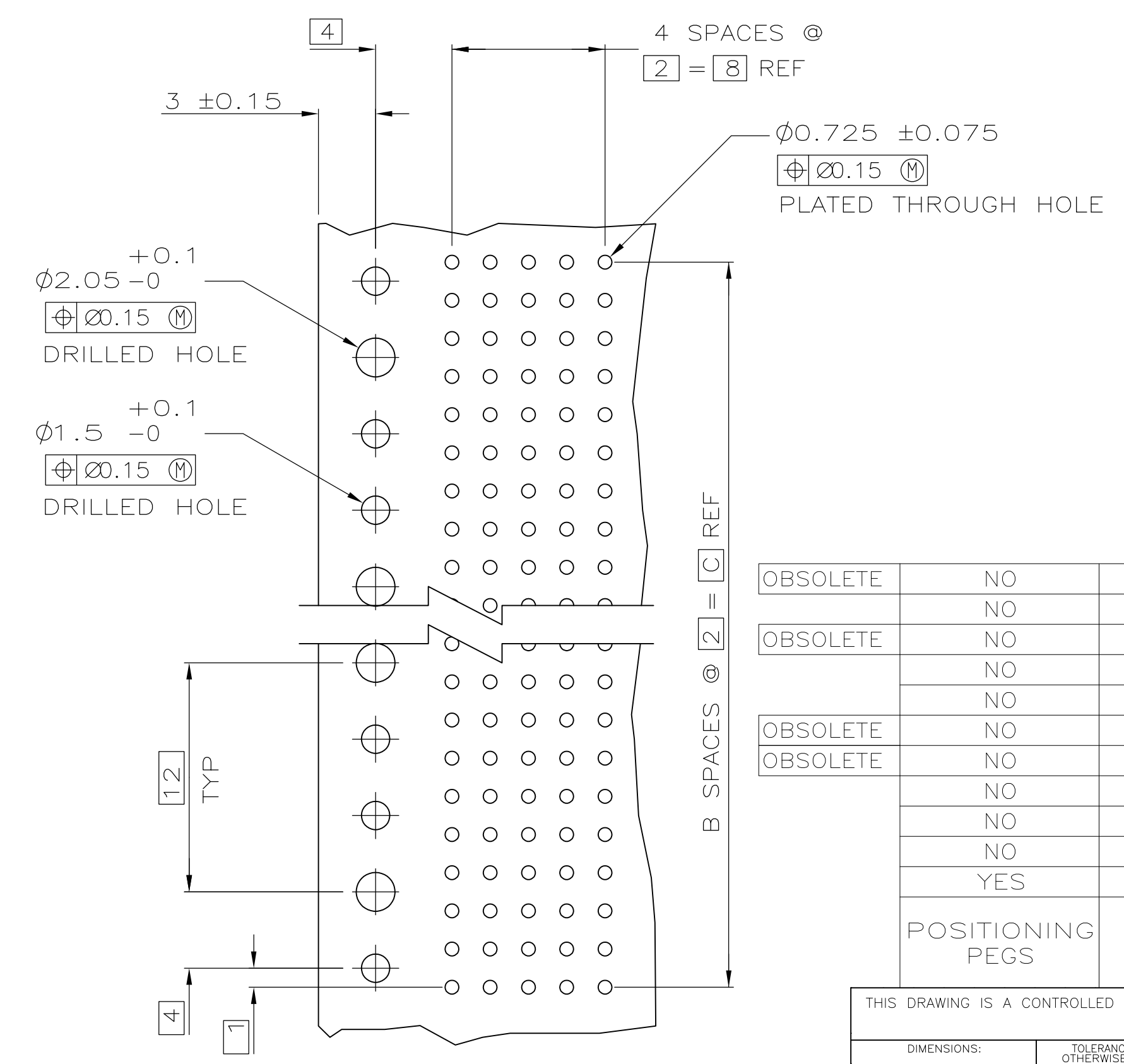
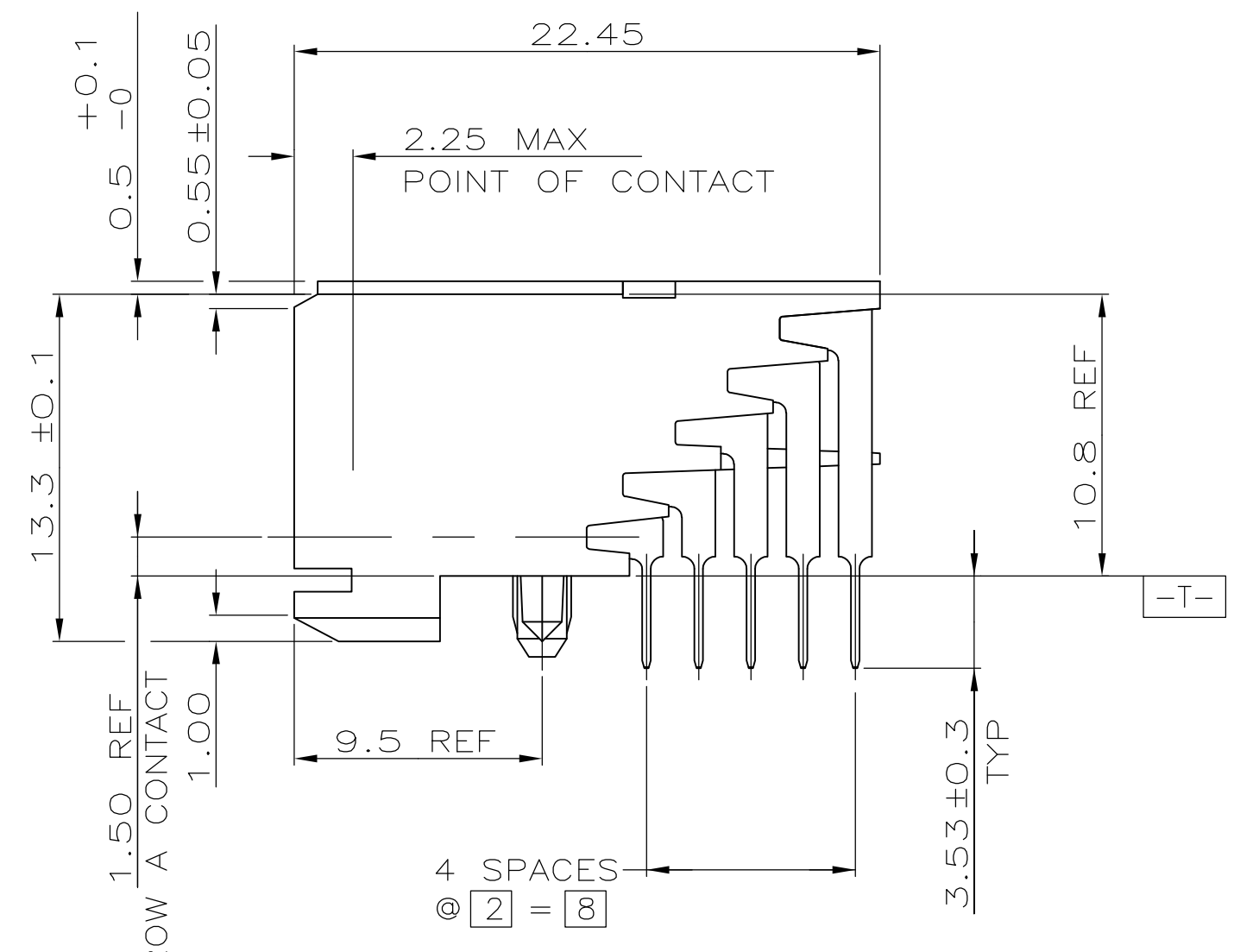
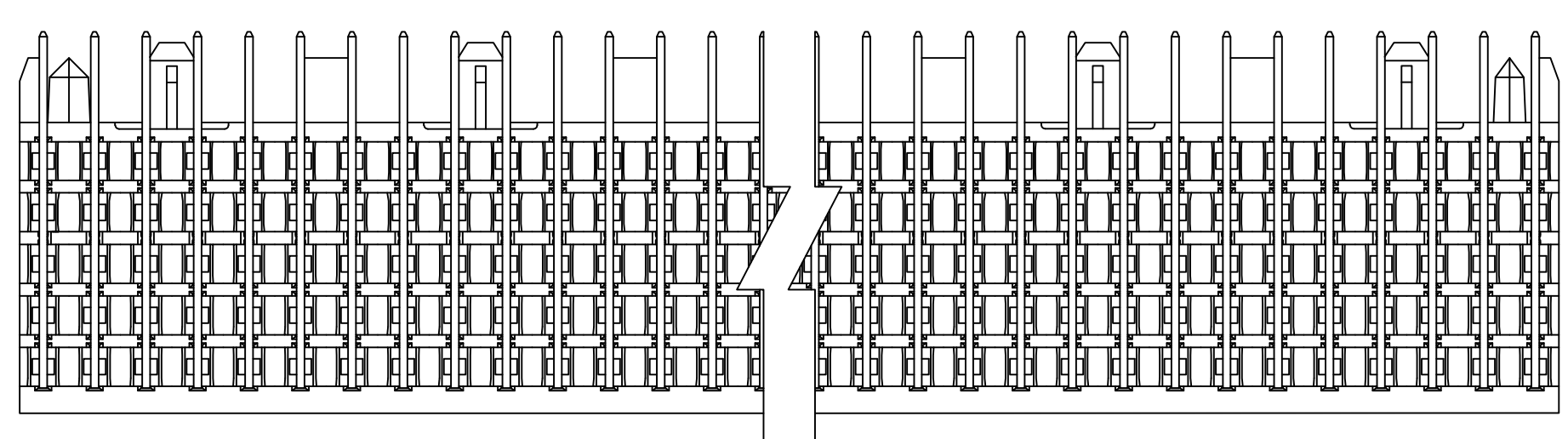
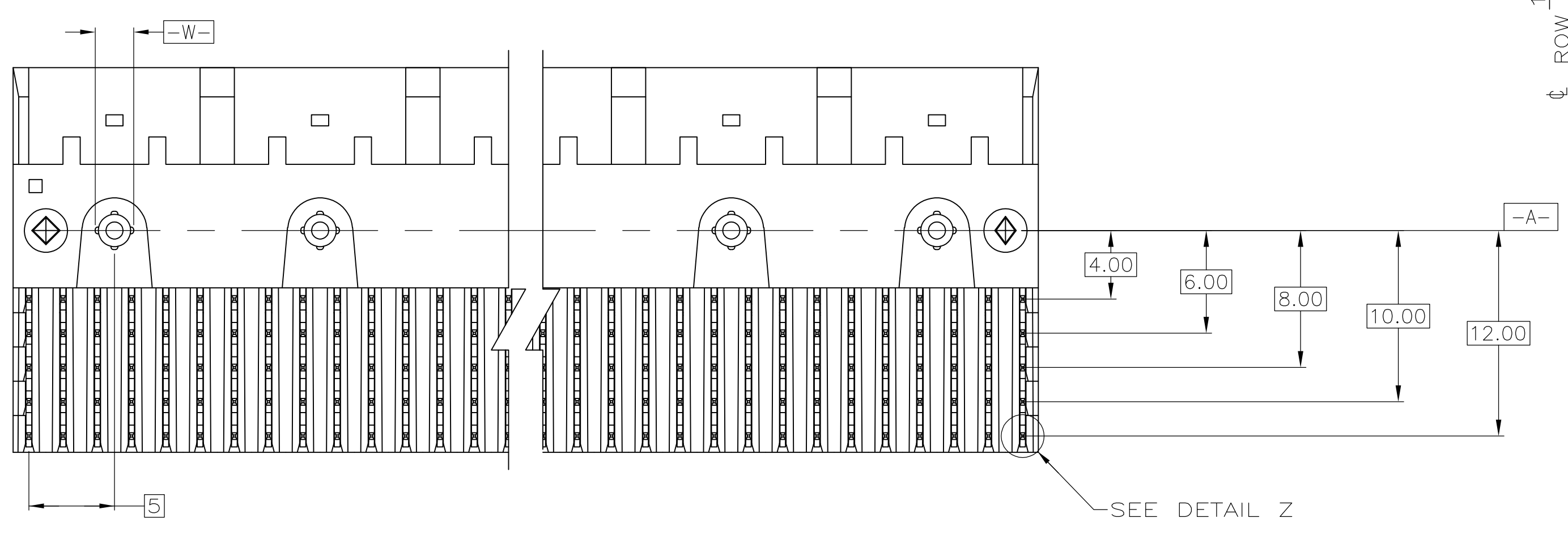
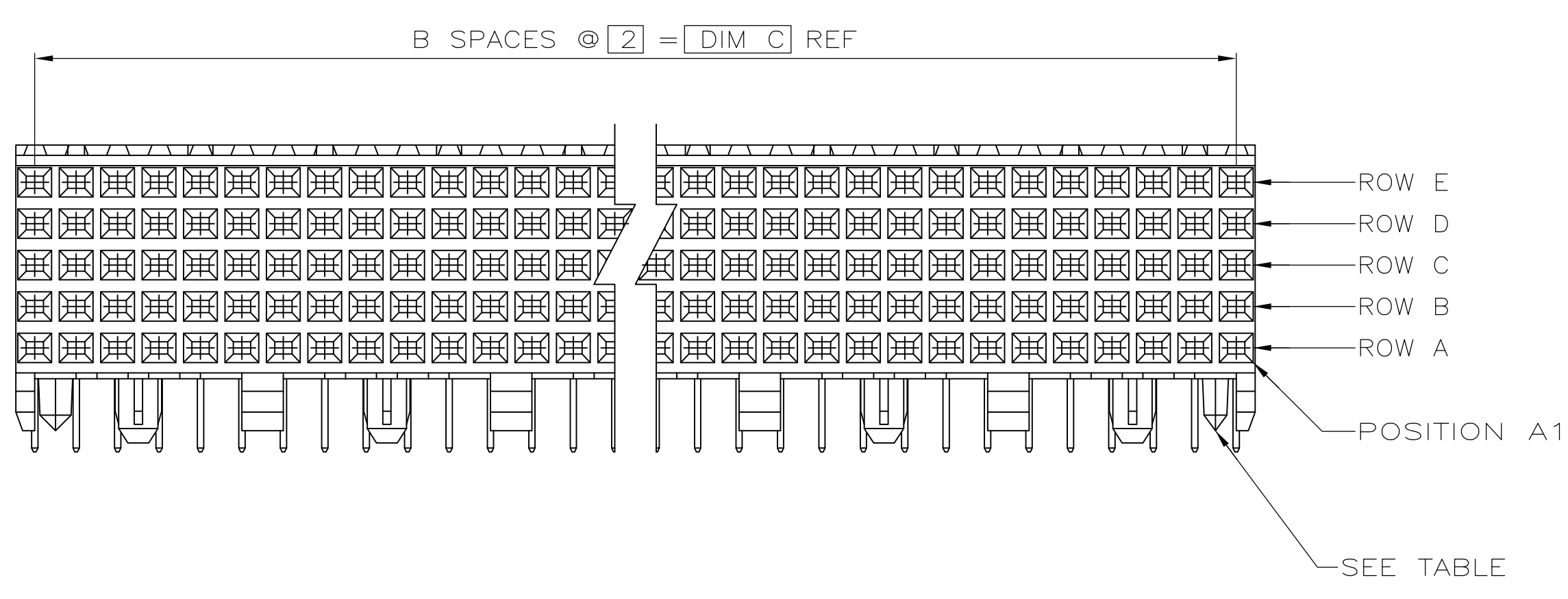
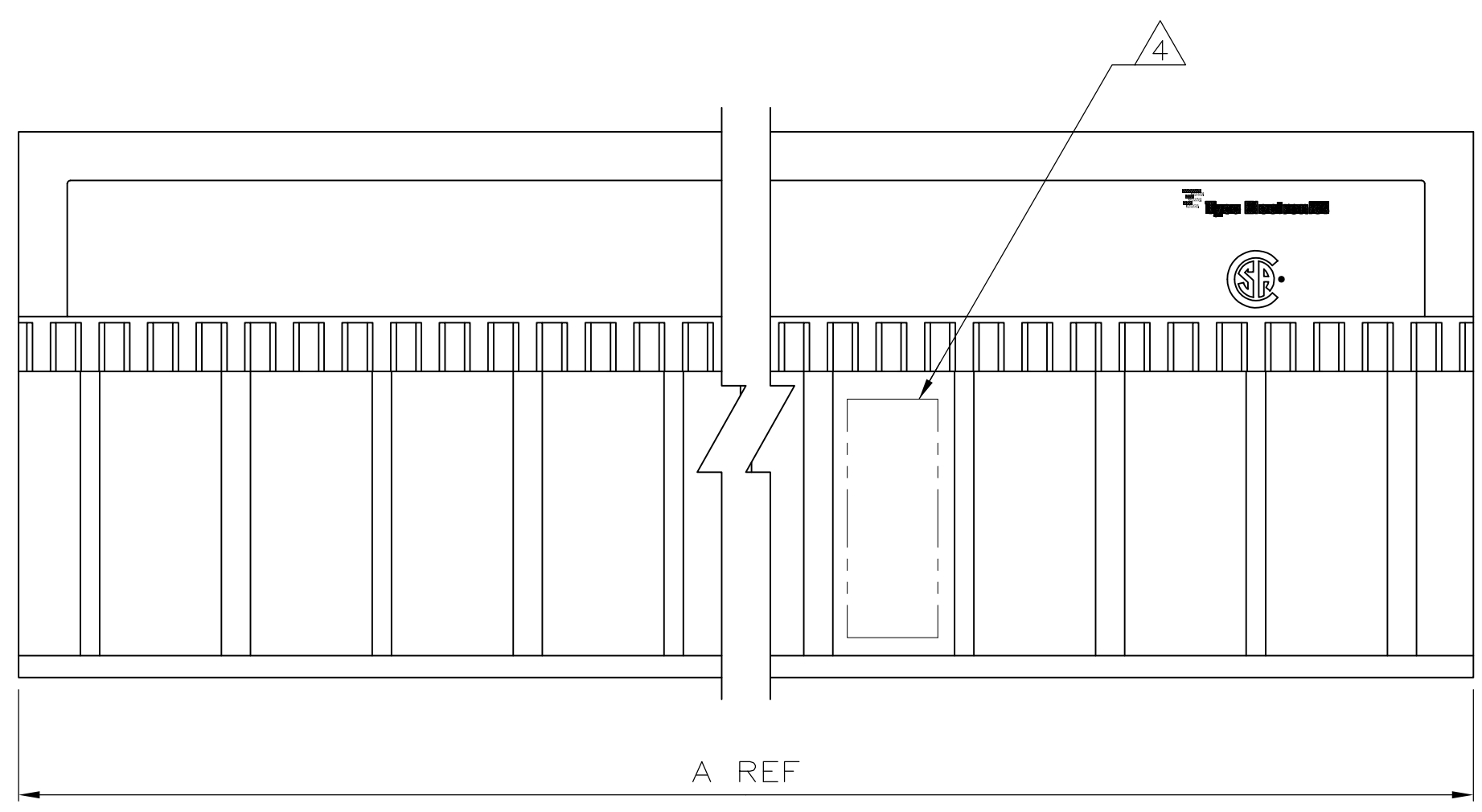

- △ HOUSING MATERIAL: LIQUID CRYSTAL POLYMER
COLOR: NATURAL.
- △ CONTACT MATERIAL: PHOSPHOR-BRONZE.
- △ CONTACT FINISH:
UNDERPLATE (ENTIRE CONTACT):
0.00127 MIN NICKEL.
ON MATING SURFACES:
CONFORMS TO ALL TESTING SPECIFIED FOR TELCORDIA
UNCONTROLLED ENVIRONMENT.
ON LEADS
0.00381 MIN TIN-LEAD OVER UNDERPLATE.
LUBRICATION (ENTIRE CONTACT):
SURFACE CONDITIONER PER AMP SPEC 112-1002 AFTER PLATING.
- △ PART MARKING LOCATED APPROXIMATELY AS SHOWN.
- △ OBSOLETE PARTS: OBSOLETE CIS STREAMLINING PER D.RENAUD/D.SINISI

OBSELETE	NO	130	65	131.88	△	330	△	1-223007-1
	NO	118	59	119.88	△	300	△	1-223007-0
OBSELETE	NO	106	53	107.88	△	270	△	223007-9
	NO	94	47	95.88	△	240	△	223007-8
	NO	82	41	83.88	△	210	△	223007-7
OBSELETE	NO	70	35	71.88	△	180	△	223007-6
OBSELETE	NO	58	29	59.88	△	150	△	223007-5
	NO	46	23	47.88	△	120	△	223007-4
	NO	34	17	35.88	△	90	△	223007-3
	NO	22	11	23.88	△	60	△	223007-2
	YES	10	5	11.88	△	30	△	223007-1
POSITIONING PEGS	C	B	A	FINISH	NO OF SIGNAL POSN	PART NUMBER		

RECOMMENDED CIRCUIT PATTERN PER IPC-D300 TYPE II, CLASS C (COMPONENT SIDE)

THIS DRAWING IS A CONTROLLED DOCUMENT.

APPROVED: R. BUCHHEISTER 08/FEB/96
CHK: D. BAECHTLE 08/FEB/96
APPROVED: D. SINISI 08/FEB/96

Tyco Electronics Corporation
Harrisburg, PA 17105-3608

NAME: ASSEMBLY, RECEPTACLE, SIGNAL, RIGHT ANGLE, Z-PACK 2mm FB, 5 ROW, SOLDER LEAD

PRODUCT SPEC: -
APPLICATION SPEC: -
SIZE: A1
CAGE CODE: 00779
DRAWING NO: C=223007

RESTRICTED TO: -
WEIGHT: -
CUSTOMER DRAWING: -
SCALE: 4:1
SHEET: 1 of 1
REV: M2