

PC card drilling dimensions (after plating)
(thickness 1.60±0.20mm)

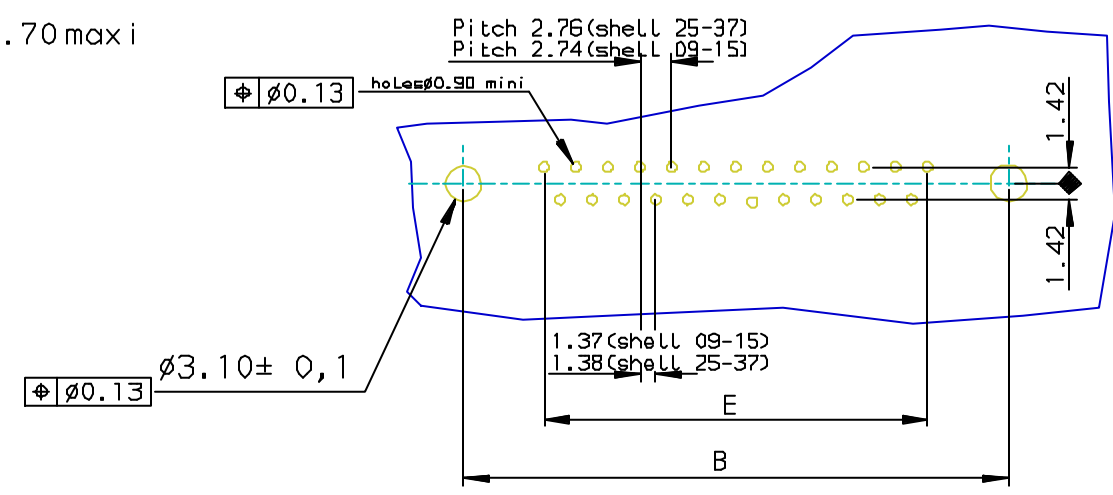

SHELL	A±0.38	B±0.12	C±0.10	D±0.25	E±0.07	PART NUMBER	PART NUMBER
09	30.81	24.99	16.96	16.21	10.96	D09S33E4PV00**	D09S33E6PV00**
15	39.14	33.32	25.18	24.54	19.18	D15S33E4PV00**	D15S33E6PV00**
25	53.03	47.04	39.12	38.25	33.12	D25S33E4PV00**	D25S33E6PV00**
37	69.32	63.50	55.68	54.71	49.68	D37S33E4PV00**	D37S33E6PV00**
						Gold flash	0,76 μ gold

LF FOR LEAD FREE

REQUIREMENTS

Technical characteristics:
 Shell: steel tin/Zinc Cr3 plated
 Insulators: self-extinguishing thermoplastic, UL class 94V0
 Contacts: phosphor bronze, gold (for thickness see table)
 over 2 μ mini nickel on active area and flash to 1.5 μ maxi SnPb
 over 1 μ mini nickel on termination.

Cycles ; 200 min for plating 4.
 Cycles ; 500 min for plating 5.

Nuts: brass, tin/Zinc Cr3 plated

Electrical characteristics:

max. current rating: 5A
 Test voltage: 1000V
 Rated voltage: 300V
 Contact resistance: ≤15mΩ
 Shell resistance: ≤5mΩ
 Insulation resistance: ≥5000MΩ

Climatic characteristics:

Operating temperature range: -55°C +125°C

Dimensions:

in accordance with MIL-C-24308

FOR ROHS DETAILS REFER DWG.NO: C01-8646-0000

European Views

www.fciconnect.com		surface ISO 1302 ✓	tolerance std ISO 406 ISO 1101	projection mm
TOLERANCES UNLESS OTHERWISE SPECIFIED				
Dr	JOHN SLEEBA	1997/09/08	ANGULAR	LINEAR
Eng	GEORGE VJ	1997/09/08	0.X	±0.1
Chr	GEORGE VJ	2005/07/27	0.XX	±0.1
Appr	KVSD	2005/07/27	0.XXX	±0.1
Product family			D-SUB	
title			SOCKET CONNECT.DELTA D RIGHT ANGLE	
catalog no			DELTA-D	
size			A3	
Scale			1:1	
ECN			-	
Spec ref			-	
Rev.			C	
dwg no			C01-8646-0556	
CUSTOMER			sheet 1 of 1	

rev	ecn no	dr	date
B	105-0124	JS	2005/07/27
C	106-0074	SK	2006/06/08
-	-	-	-
-	-	-	-
-	-	-	-
-	-	-	-



Copyright FCI.