

P.C. MOUNTING

| SWITCH FUNCTION | | |
|-----------------|--------|--------|
| POS. 1 | POS. 1 | POS. 1 |
| | | |
| ON | NONE | ON |
| 2-3 | OPEN | 2-1 |

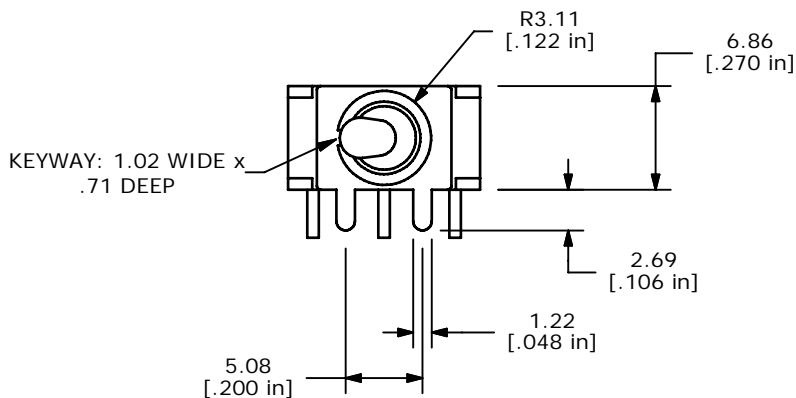

ISOMETRIC

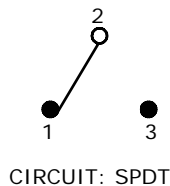
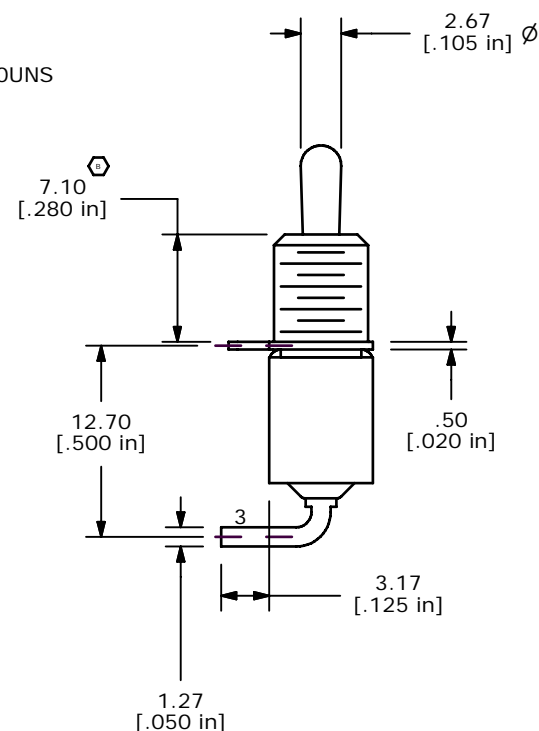
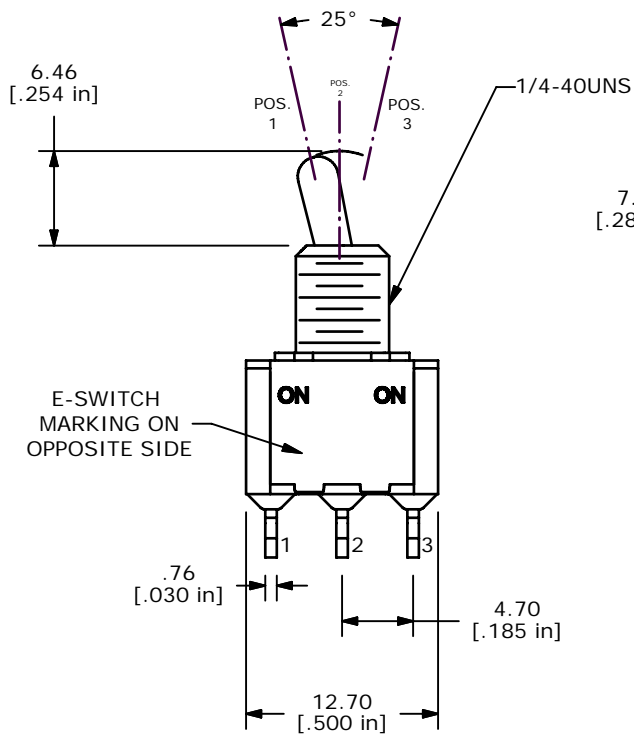
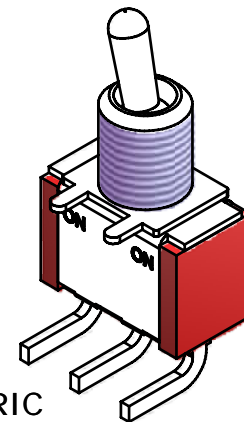

NOTE:

1. ALL DIMENSIONS IN MM [INCH]
2. GENERAL TOLERANCE: X.X=±0.4
X.XX=±0.25
3. TERMINAL NUMBERS FOR REF ONLY
- ▲ 4. PLATING MATERIAL: GOLD
5. RATING: 0.4VA @ 20VAC OR VDC
6. ELECTRIC LIFE: 40,000 MAKE-AND-BREAK CYCLES AT FULL LOAD.
7. INSULATION RESISTANCE: 1,000 MEGA-OHM MIN.
8. DIELECTRIC STRENGTH: 1,000 V RMS @SEA LEVEL.
9. OPERATING TEMP.: -30°C to 85°C
10. ▲ DENOTES CRITICAL PARAMETER.

E-SWITCH®

| | | | | |
|-----|--------|------------------------|----------|-----|
| B | 17875 | dim 7.10 was 7.31 | 11/26/07 | rc |
| A | 17866 | RELEASE FOR PRODUCTION | 11/19/07 | BLR |
| REV | PCR NO | DESCRIPTION | DATE | BY |

| | | | | |
|----------------------|-----------------|--------|-------------|-------|
| TITLE 100SP1T2B3M6RE | | | | |
| SCALE 2:1 | DATE 11/19/2007 | DR BLR | DWG T111117 | REV B |

THE INFORMATION CONTAINED IN THIS DOCUMENT IS PROPRIETARY TO E-SWITCH AND IS NOT TO BE COPIED OR TRANSFERRED