

Device connector, front mounting - CA-07S1N222S00 - 1619953

Please be informed that the data shown in this PDF Document is generated from our Online Catalog. Please find the complete data in the user's documentation. Our General Terms of Use for Downloads are valid (<http://phoenixcontact.com/download>)



Device connector for front wall, straight, shielded: yes, SPEEDCON locking, M23, Number of positions: 7, Type of contact: Socket, Solder-in connection, Flat gasket, 4x Ø3.2, Flange dimensions: 25 mm x 25 mm

The figure shows the 6-pos. product version



Key Commercial Data

| | |
|----------------------|----------|
| Packing unit | 1 pc |
| Custom tariff number | 85366990 |
| Country of origin | Germany |

Technical data

Temperature range

| | |
|---------------------------------|-------------------|
| Ambient temperature (operation) | -40 °C ... 125 °C |
|---------------------------------|-------------------|

Dimensions

| | |
|------------------------|--------|
| free solder pin length | 3.5 mm |
|------------------------|--------|

Data of the insulating body

| | |
|---|----------------------|
| Coding | N |
| Insulator material | PBT |
| Contact material | CuZn |
| Contact surface material | Ni/Au |
| Contact connection method | Solder-in connection |
| Type of contacts | Socket |
| Number of positions | 7 |
| Contact diameter of power contacts | 2 mm |
| Nominal current per power contact at 25°C | 20 A |
| Nominal voltage, power contact | 300 V |
| Overvoltage category | II |

Device connector, front mounting - CA-07S1N222S00 - 1619953

Technical data

Data of the insulating body

| | |
|---------------------|---|
| Degree of pollution | 3 |
|---------------------|---|

Housing data

| | |
|--|------------------|
| Housing material | CuZn |
| Flange dimensions | 25 mm x 25 mm |
| Type of locking | SPEEDCON locking |
| Degree of protection (when plugged in) | IP67 |
| Thread type | M23 |

Classifications

eCl@ss

| | |
|------------|----------|
| eCl@ss 4.0 | 272607xx |
| eCl@ss 4.1 | 27260701 |
| eCl@ss 5.0 | 27143424 |
| eCl@ss 5.1 | 27143424 |
| eCl@ss 6.0 | 27143424 |
| eCl@ss 7.0 | 27440209 |
| eCl@ss 8.0 | 27440103 |

ETIM

| | |
|----------|----------|
| ETIM 3.0 | EC001121 |
| ETIM 4.0 | EC002635 |
| ETIM 5.0 | EC002061 |

UNSPSC

| | |
|---------------|----------|
| UNSPSC 6.01 | 43172015 |
| UNSPSC 7.0901 | 43201404 |
| UNSPSC 11 | 43172015 |
| UNSPSC 12.01 | 43201404 |
| UNSPSC 13.2 | 43201404 |

Approvals

Approvals

Approvals

UL Recognized / cUL Recognized / EAC / cULus Recognized

Device connector, front mounting - CA-07S1N222S00 - 1619953

Approvals

Ex Approvals

Approvals submitted

Approval details

| | |
|---|-------|
| UL Recognized  | |
| mm ² /AWG/kcmil | 14 |
| Nominal current I _N | 20 A |
| Nominal voltage U _N | 300 V |

| | |
|--|-------|
| cUL Recognized  | |
| mm ² /AWG/kcmil | 14 |
| Nominal current I _N | 10 A |
| Nominal voltage U _N | 300 V |

EAC

| | |
|--|--|
| cULus Recognized  | |
|--|--|

Drawings

Device connector, front mounting - CA-07S1N222S00 - 1619953

Schematic diagram

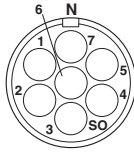

7-pos.

Drilling diagram

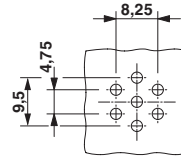

Dimensional drawing

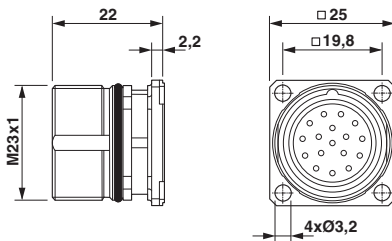

Dimensional drawing

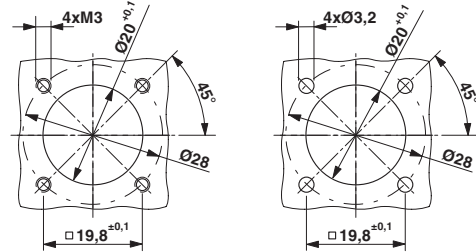

Installation dimensions