

回路番号 1 マーク
CKT. NO.1 MARK

トレードマーク
TRADE MARK

キャビティ番号及び金型番号
CAVITY NO. & MOLD NO.

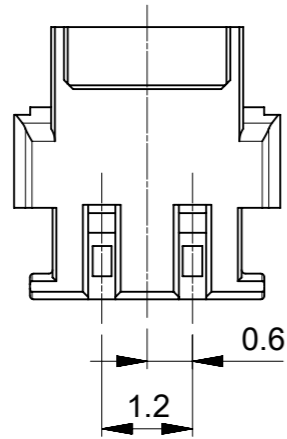
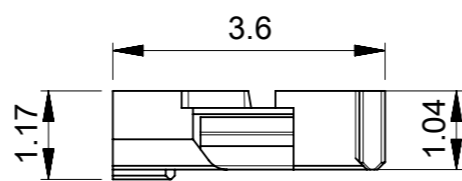
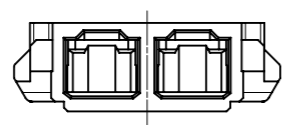
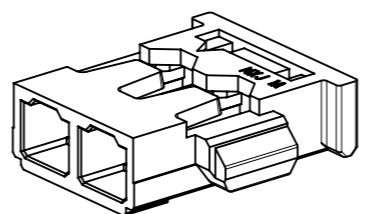
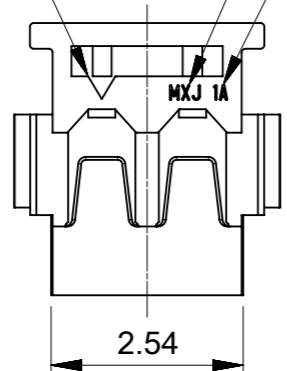

注記 : 1. 材質 ハウジング : ポリアミド(PA) , UL94V-0,色 : 黒
NOTE : MATERIALS HOUSING: PA, UL94V-0, COLOR:BLACK

2. 嵌合相手 : 2026560021
MATING WITH : 2026560021

3. 適合ターミナル : 2026555000
APPLICABLE TERMINAL : 2026555000

4. 梱包形態 : 袋詰め梱包
PACKING SPECIFICATION : PLASTIC BAG PACKAGING

RECEPTACLE HOUSING
2026542021

PLUG HEADER
2026562021

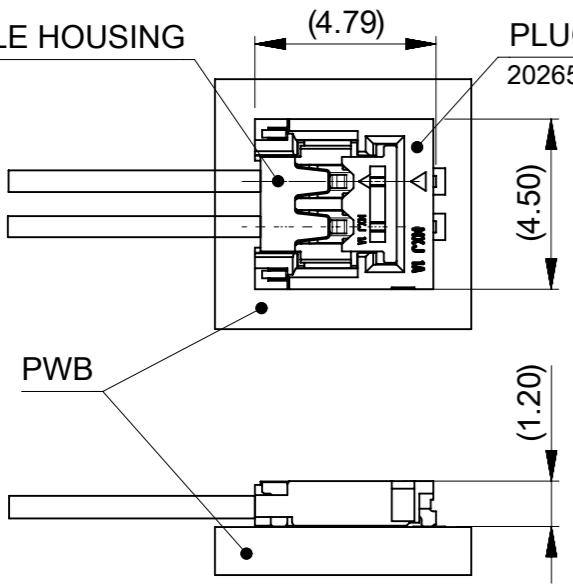

嵌合状態図
MATING FIGURE
(SCALE 5:1)

2026542021	2	2026542**1
ORDER NO.	CKT	MODEL NO.

THIS DRAWING CONTAINS INFORMATION THAT IS PROPRIETARY TO MOLEX ELECTRONIC TECHNOLOGIES, LLC AND SHOULD NOT BE USED WITHOUT WRITTEN PERMISSION

EC NO: 116096 DRWN: SSHIMONISHI CHK'D: KOMURAKAMI APPR: TKANEKO	2017/06/08	2017/06/12	2017/06/12	GENERAL TOLERANCES (UNLESS SPECIFIED) ANGULAR TOL ± 3.0 ° 4 PLACES ± 0.2 3 PLACES ± 0.2 2 PLACES ± 0.2 1 PLACE ± 0.2 0 PLACES ± 0.2 DRAFT WHERE APPLICABLE MUST REMAIN WITHIN DIMENSIONS	DIMENSION UNITS	SCALE	<p>PICO-EZMATE SLIM 1.2 W/B RECEPTACLE HOUSING</p> <p>PRODUCT CUSTOMER DRAWING</p>	
	RELEASED				MM	10:1		SERIES: 202654 MATERIAL NUMBER: SEE CHART CUSTOMER: GENERAL
					DRWN BY	DATE		
					TAKAIKE	2017/04/07		
					CHK'D BY	DATE		
			KOMURAKAMI	2017/06/08				
			APPR BY	DATE				
			TKANEKO	2017/06/12				
			DRAWING SIZE	THIRD ANGLE PROJECTION				
			A3					