

FRONT SHELL

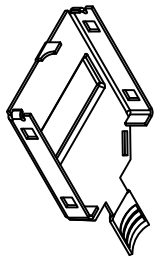

INSERTED BODY

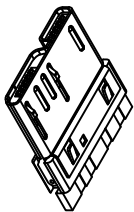

REAR SHELL

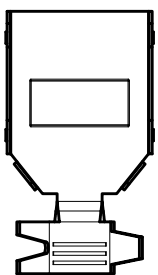
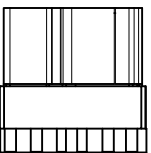
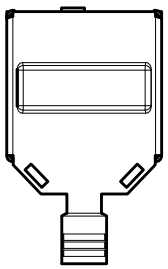
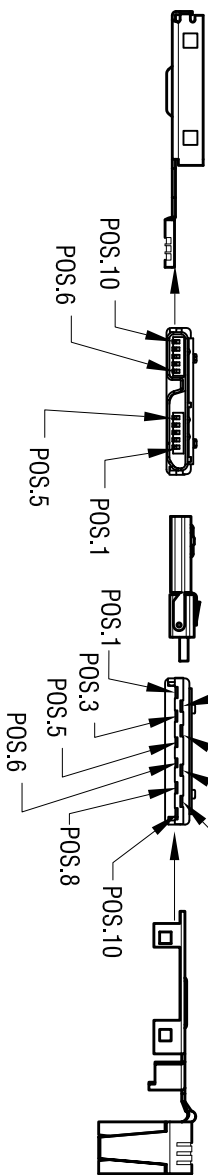
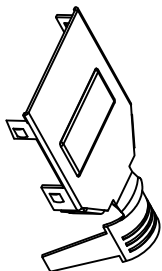

ASSEMBLED PLUG

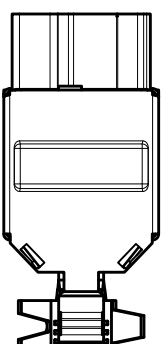
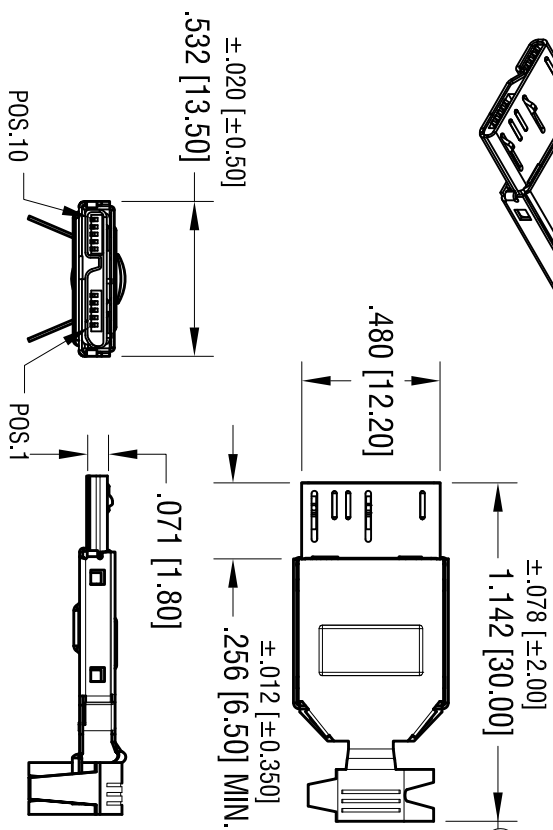
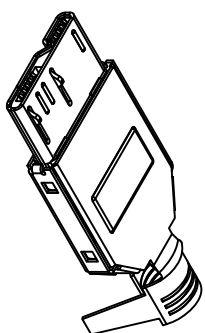

**PLUG SPECIFICATIONS:**

- SHELL: MAT'L- STEEL
- FINISH- NICKEL PLATE
- CONTACT: MAT'L- PHOSPHOR BRONZE
- FINISH- GOLD FLASH OVER NICKEL
- INSULATION: MAT'L- THERMOPLASTIC, UL 94V-0

**ELECTRICAL CHARACTERISTICS:**

- RATED VOLTAGE: 30V (RMS)
- CONTACT CURRENT RATING: 1.8 Amp DC MAX.
- CONTACT RESISTANCE: 50m Ω max.

**MECHANICAL CHARACTERISTICS:**

- DIELECTRIC WITHSTANDING VOLTAGE: AC 100 V R.M.S.
- OPERATING TEMPERATURE: -13°F (-25°C) TO 176°F (+80°C)
- DURABILITY: 1500 CYCLES MIN.

DATE	DESCRIPTION	REV.
6.01.11	CHANGE AS PER ECN 11-076	A
3.26.15	CHANGE AS PER ECN 15-040 (B1) WAS 1.008 [25.60]	B
9.01.16	CHANGE AS PER ECN 16-082 UPDATE SHELL	C

**KEYSTONE ELECTRONICS CORP.**  
 www.keystone.com • ASTORIA, N.Y. 11105-2017 • Tel (718) 956-8900

PART NAME: **USB 3.0 MICRO PLUG**

MATERIAL: **AS NOTED**

FINISH: **AS NOTED**

TOLERANCES	INCH	[MM]	CODE	DWG NO.
DECIMAL	± .010	[± 0.25 ]	C	957
ANGULAR	± 1°			

THIS DOCUMENT IS THE PROPERTY OF  
 KEYSTONE ELECTRONICS CORP. AND  
 SHALL NOT BE REPRODUCED, DISTRIBUTED  
 OR USED AS A BASIS FOR MANUFACTURE  
 WITHOUT PRIOR WRITTEN PERMISSION  
 FROM KEYSTONE ELECTRONICS CORP.

DRN BY	DATE
NT	8.11.10
APP'D	SCALE
LN	1.5X