

ISOMETRIC

SWITCH FUNCTION	POS. 1	POS. 2	POS. 3
ON			
2-1	N/A	N/A	2-3

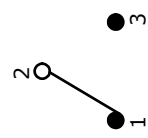

CIRCUIT: SPDI

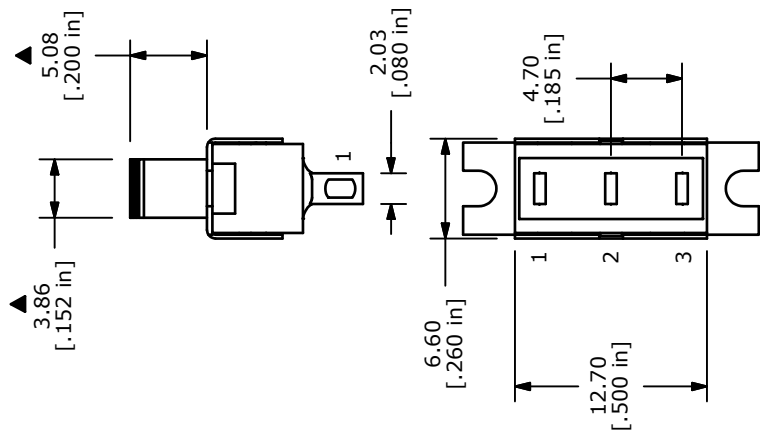
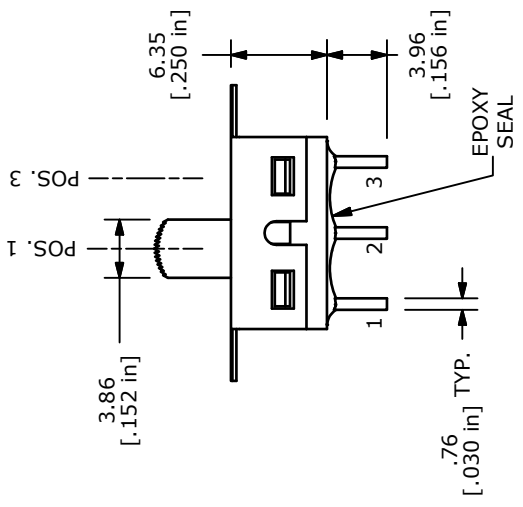

- NOTE:
- ALL DIMENSIONS IN MM [INCH]
  - GENERAL TOLERANCE: X.X=±0.4  
X.XX=±0.25
  - TERMINAL NUMBERS FOR REF ONLY
  - PLATING MATERIAL: SILVER
  - CONTACT RATING: 5A @120VAC OR 28VDC, 2A @250VAC
  - ELECTRIC LIFE: 30,000 ACTUATIONS AT FULL LOAD.
  - INSULATION RESISTANCE: 1,000 MEGA-OHM MIN.
  - DIELECTRIC STRENGTH: 1,000 V RMS @SEA LEVEL.
  - OPERATING TEMP.: -30°C to 85°C
  - ▲ DENOTES CRITICAL PARAMETER.
  - CONTACT RESISTANCE: 10m OHM MAX INITIAL @ 2-4VDC
  - 2002/95/EC (ROHS) COMPLIANT.



TITLE 500SSP2S1M1QEB		DRAWING UPDATE 1/5/11		BGL	
SCALE 2:1		DATE 1/5/2011		DR BGL	
DWG T531003		REV B			

THE INFORMATION CONTAINED IN THIS DOCUMENT IS PROPRIETARY TO E-SWITCH AND IS NOT TO BE COPIED OR TRANSFERRED