

| REVISONS |                  | DATE     | BY | APP'D |
|----------|------------------|----------|----|-------|
| A        | FIRST VERSION    | 17/02/04 | GF | SM    |
| B        | ADD NEW PART No. | 27/04/05 | GF | SM    |

NOTES :

△ MATERIALS AND FINISH:

- HOUSING: PA66  
 - CONTACTS: COPPER ALLOY, FINISH: TIN OVER NICKEL UNDERPLATE

2. MUST COMPLY WITH DIRECTIVE 2002/95/EC (ROHS)

3. WIRE TYPES AND SIZES ACCEPTED

WIRE RANGE: 20AWG~26AWG(SOLID&STRANDED)  
 STRIP LENGTH: 7.5mm~8.5mm

4. PACKAGED IN TRAY.

5. CURRENT RATING: 5Amp AC300V.

6. OPERATION TEMPERATURE: -40°C TO +105°C

PCB Layout

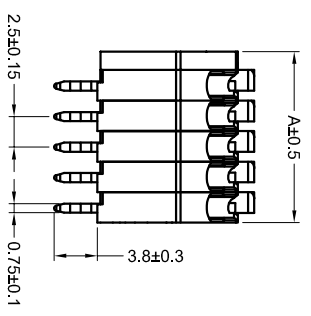
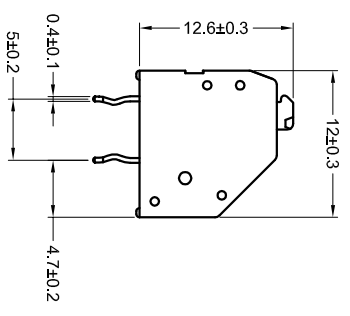
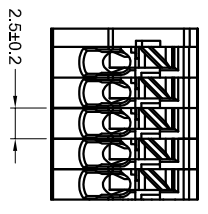
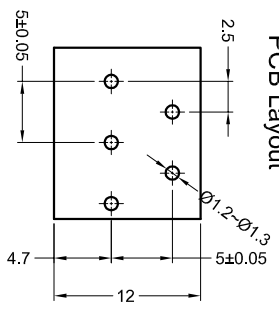

COLOR CODE:

- 1=GREEN
- 2=BLUE
- 3=BROWN
- 4=ORANGE
- 5=GREY
- 6=RED
- 7=YELLOW
- 8=PURPLE
- 9=WHITE
- 0=BLACK

SERIES CODE

- 2=2 POSN
- 3=3 POSN
- 4=4 POSN
- 5=5 POSN
- 6=6 POSN
- 7=7 POSN
- 8=8 POSN

PIN No:

| NO. OF POSITIONS | 21.50  | 19.00  | 16.50  | 14.00  | 11.50  | 9.00   | 6.50   | A |
|------------------|--------|--------|--------|--------|--------|--------|--------|---|
| 8 POSN           | 8 POSN | 7 POSN | 6 POSN | 5 POSN | 4 POSN | 3 POSN | 2 POSN |   |

REMARK: THE DIFFERENT COLORS COULD BE COMBINED TO THE NEW CONNECTOR P/Ns FOR CUSTOMER REQUEST.

THIS DRAWING IS A CONTROLLED DOCUMENT.

|                  |          |            |
|------------------|----------|------------|
| DESIGNER         | CHK'D    | DATE       |
| W. YUANG         | W. YUANG | 11-4-13/08 |
| DRWING NO.       | REV      | DATE       |
| 108-137084       | 1        | 11-4-13/08 |
| CUSTOMER DRAWING |          |            |



TE Connectivity

2.50mm Pitch Modular Screwless Conn.

SIZE 1 CODE 00779 -2834021