

PRODUCT NUMBER	PITCH
YK313xx0x0JOG	7.62 mm

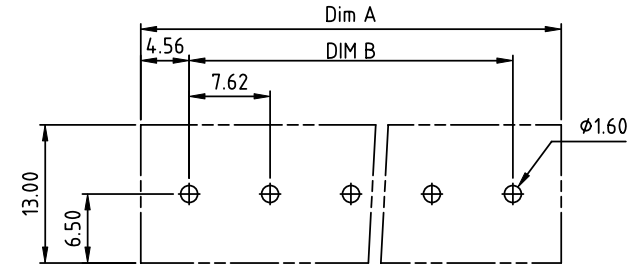

RECOMMENDED P.C.B LAYOUT
TOP VIEW

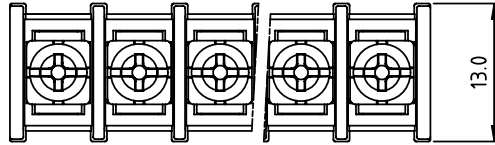
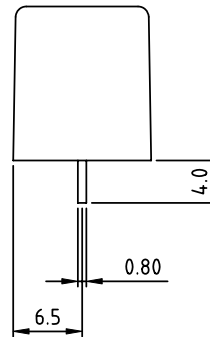
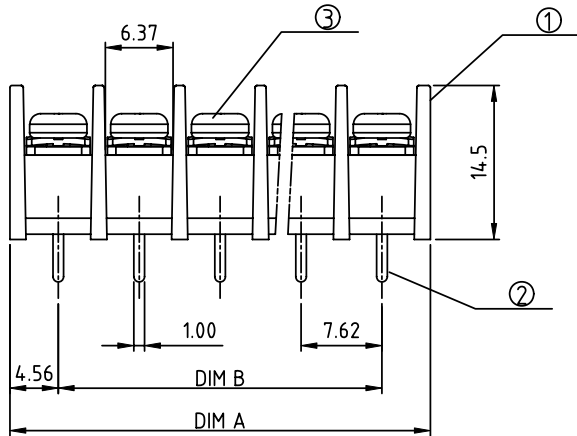

MATERIALS & ELECTRICAL
 RATED VOLTAGE & CURRENT: 250 V, 15 A
 WITHSTAND VOLTAGE: AC 2000 V/Min
 INSULATION RESISTANCE: 1000 M Ω OR MORE AT DC 500 V
 OPERATING TEMPERATURE RANG: -40 °C ~ +115 °C
 SCREW TORQUE VALUE: 5.3 Lb-In.
 WIRE RANGE: 22 - 16 AWG
 1) HOUSING: THERMOPLASTIC, UL 94 V-0 BLACK
 2) TERMINAL: BRASS, 0.8t
 3) TERMINAL SCREWS: STEEL, M3
 APPROVAL:

DIMENSION

Dim A	(N-1)×7.62+9.12
Dim B	(N-1)×7.62

N=Number of poles

Poles	Tolerance
2p-5p	±0.20
6p-10p	±0.25
11p-16p	±0.35
17p-24p	±0.40
25p-30p	±0.50

PART NO.: YK 313xx 0 x 0 JOG

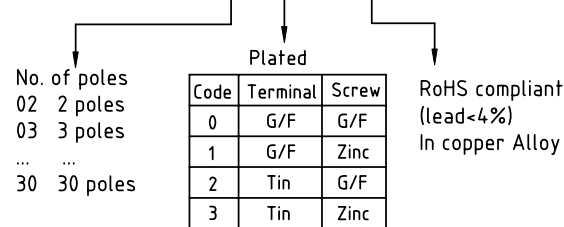

Code	Terminal	Screw
0	G/F	G/F
1	G/F	Zinc
2	Tin	G/F
3	Tin	Zinc

mat'l. code		surface ASME Y14.5	tolerance ASME Y14.5	projection 	product family TERMINAL BLOCK
ltr	ecn no	dr	date	tolerances unless otherwise specified	title TERMINAL BLOCK
				angles 	BARRIER TYPE
				X±1°	scale MM
				dr EVAN LU 061014	dwg no YK313xx0x0JOG
				enr EVAN LU 061014	sheet 1 of 1 size A4
				chr HANKE FENG 061014	type CUSTOMER Drawing
				appd SHI JUN 061014	
sheet index	revision sheet	A	1		