

10 9 8 7 6 5 4 3 2 1

PART NO IN TRAY	CKT SIZE	DIMENSION	
		A	B
87937-0106	1	2.54	-----
87937-0206	2	5.08	2.54
87937-0406	4	10.16	7.62
87937-0502	5	12.70	10.16
87937-0802	8	20.32	17.78
87937-1206	12	30.48	27.94
87937-1406	14	35.56	33.02

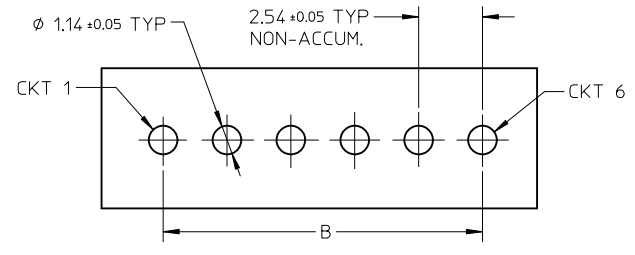

RECOMMENDED P.C.B HOLE LAYOUT

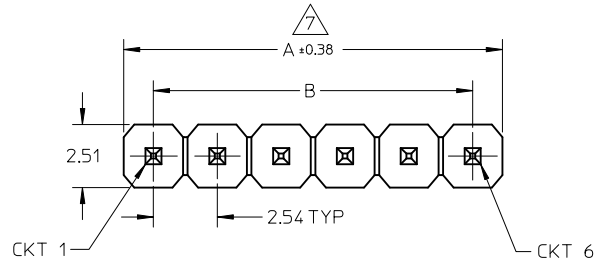
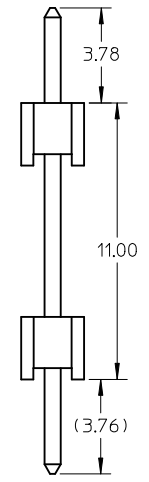
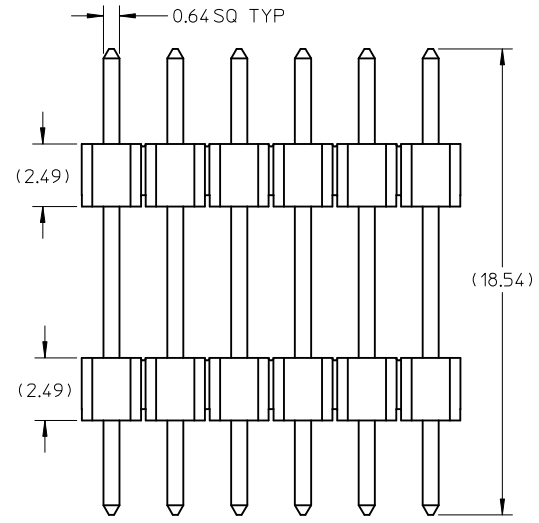

- NOTES:
- MATERIAL:  
HOUSING: 30% G.F. POLYESTER, UL94V-0,  
COLOR: BLACK  
TERMINAL: COPPER ALLOY
  - PLATING TYPE:  
(6) : 100 MICRO INCHES MIN. TIN IN SELECTED AREA OVER  
50 MICRO INCHES MIN. NICKEL OVERALL.
  - PIN PUSHOUT FORCE: 1KG MIN IN EITHER DIRECTION
  - PACKAGING SPECIFICATION: PK-89990-489
  - THE ABOVE 6 CKT IS FOR ILLUSTRATION PURPOSE ONLY.
  - PART TO BE PACK IN TRAY.
  - IRREGULAR CIRCUIT CUTOFF WITHIN BREAKAWAY SECTION IS PERMISSIBLE. CUTTING OR CHIPPING OF THE MAIN BODY IS NOT ACCEPTABLE.

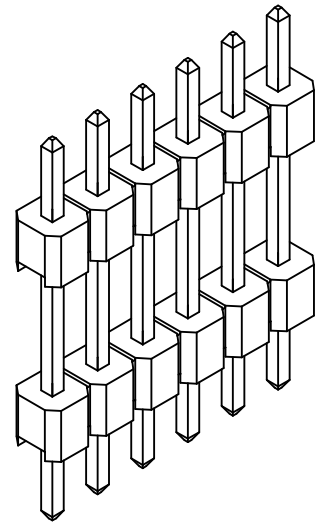

0145-CN +879370206/1406 EC NO: S2012-0562 DRWN:ATSEE 2012/01/20 CHKD:SKANG 2012/03/20 APPR:MLONG 2012/03/20	QUALITY SYMBOLS	GENERAL TOLERANCES (UNLESS SPECIFIED)		DIMENSION STYLE MM ONLY		SCALE NTS	DESIGN UNITS METRIC	THIRD ANGLE PROJECTION
	$F_A=0$	4 PLACES	mm	INCH	DRAWN BY KCHO	DATE 2005/05/25	TITLE CUSTOM HEADER	
	$F_B=0$	3 PLACES	± ---	± ---	CHECKED BY BOKOK	DATE 2005/06/13	C-GRID SINGLE ROW HEADER	
	$F_C=0$	2 PLACES	± 0.20	± ---	APPROVED BY PTLIM	DATE 2005/06/13	DUAL WAFER TROUGH HOLE	
		1 PLACE	± ---	± ---	MATERIAL NO. SEE TABLE		MOLEX INCORPORATED	
			ANGULAR ± 3°		DOCUMENT NO. SD-87937-002		SHEET NO. 1 OF 1	
			DRAFT WHERE APPLICABLE MUST REMAIN WITHIN DIMENSIONS		THIS DRAWING CONTAINS INFORMATION THAT IS PROPRIETARY TO MOLEX INCORPORATED AND SHOULD NOT BE USED WITHOUT WRITTEN PERMISSION			

9 8 7 6 5 4 3 2 1