

RECOMMENDED PCB LAYOUT

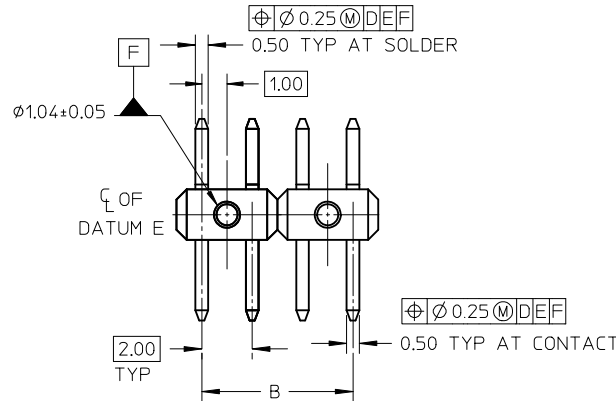

- NOTES:
- MATERIAL:
HSG: LCP, GLASS-FILLED, UL94V-0, COLOR:BLACK
PIN: 0.50mm SQ, COPPER ALLOY
 - PLATING:
(1) 2.540µm TIN OVERALL PLATING OVER NICKEL OVERALL
(2) 5.080µm TIN OVERALL PLATING OVER NICKEL OVERALL
 - PACKAGING TYPE: SEE TABLE
 - PACKAGING SPECIFICATION:
TRAY: PK-89990-487
TAPE & REEL: PK-89990-484
 - PRODUCT SPEC PS-87761-100 APPLIES
 - IRREGULAR CIRCUIT CUTOFF WITHIN BREAKAWAY SECTION IS PERMISSIBLE. MEASUREMENT AT BOTH ENDS, FROM CUT END TO THE CENTRELINE OF THE HOUSING CORE HOLE OF THE FIRST PIN REMAINS AT 1.00±0.20MM. CUTTING AND CHIPPING OF THE MAIN BODY IS NOT ACCEPTABLE.
 - THE ABOVE CKT 4 IS FOR ILLUSTRATION PURPOSE ONLY
 - COPLANARITY IS TO BE MEASURED BY RESTING THE SOLDER TAIL ON A GAUGE SURFACE
 - KAPTON TAPE LOCATION IS CENTERED ALONG THE PART AS SHOWN.
 - RECOMMENDED PCB BOARD THICKNESS: 1.60±0.10mm

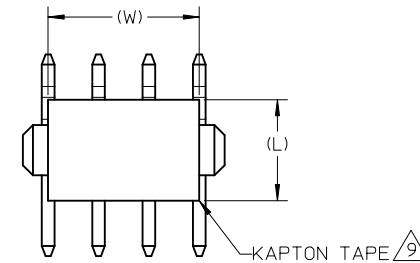

ADD P/N: 87858-0005 EC NO: S2011-0457 DRWN:SKANG 2010/11/18 CHYD:ATSEE 2010/11/29 APPR:MLONG 2010/12/01	QUALITY SYMBOLS ▽=0 ◻=0	GENERAL TOLERANCES (UNLESS SPECIFIED)		DIMENSION STYLE MM ONLY	SCALE NTS	DESIGN UNITS METRIC	THIRD ANGLE PROJECTION		
		4 PLACES ± --- ± --- 3 PLACES ± --- ± --- 2 PLACES ± 0.2 ± --- 1 PLACE ± --- ± ---	mm INCH	DRAWN BY KSEE	DATE 2003/11/14	TITLE CUSTOM HEADER 2MM SINGLE ROW HDR IN SMT WITH PEG, BREAKAWAY			
		ANGULAR ± 3 °		CHECKED BY KCL ING	DATE 2003/12/15	MOLEX INCORPORATED			
		DRAFT WHERE APPLICABLE MUST REMAIN WITHIN DIMENSIONS		APPROVED BY PTL IM	DATE 2003/12/15	MATERIAL NO. SEE TABLE	DOCUMENT NO. SD-87858-001	SHEET NO. 1 OF 3	

CKT SIZE	DIMENSION			PART NO. IN TAPE & REEL PACKAGING	PART NO. IN TRAY PACKAGING	CKT SIZE	PEG	PLATE OPT.	VOID POSITION	KAPTON TAPE	DIMENSION					PACKAGING TYPE
	A	B	C								F	MATING END	SOLDER TAIL	KAPTON TAPE		
											F	M	P	W	L	
02	4.00	2.00	-	-	87858-0002	2	Y	1	----	N	8.00	3.20	2.80	-	-	-
04	8.00	6.00	4.00	87858-0250	-	2	N	1	----	Y	8.00	3.20	2.80	4.00	3.00	T1
06	12.00	10.00	8.00	87858-0003	87858-0001	2	Y	1	----	N	10.80	6.00	2.80	-	-	T2
08	16.00	14.00	12.00	87858-0005	87858-0006	2	N	1	----	N	10.80	6.00	2.80	-	-	T2
10	20.00	18.00	16.00	-	87858-0004	4	Y	1	----	N	8.00	3.20	2.80	-	-	-
12	24.00	22.00	20.00	87858-0450	-	4	N	1	----	Y	8.00	3.20	2.80	4.00	4.00	T1
14	28.00	26.00	24.00	87858-0460	-	4	N	1	----	Y	8.97	4.17	2.80	4.00	4.00	T1
16	32.00	30.00	28.00													
18	36.00	34.00	32.00													
20	40.00	38.00	36.00													

ADD P/N: 87858-0005 EC NO: S2011-0457 DRWN:SKANG 2010/11/18 CHKD:ATSEE 2010/11/29 APPR:MLONG 2010/12/01	QUALITY SYMBOLS =0 =0	GENERAL TOLERANCES (UNLESS SPECIFIED) <table border="1"> <tr> <th></th> <th>mm</th> <th>INCH</th> </tr> <tr> <td>4 PLACES</td> <td>± ---</td> <td>± ---</td> </tr> <tr> <td>3 PLACES</td> <td>± ---</td> <td>± ---</td> </tr> <tr> <td>2 PLACES</td> <td>± 0.2</td> <td>± ---</td> </tr> <tr> <td>1 PLACE</td> <td>± ---</td> <td>± ---</td> </tr> </table>		mm	INCH	4 PLACES	± ---	± ---	3 PLACES	± ---	± ---	2 PLACES	± 0.2	± ---	1 PLACE	± ---	± ---	DIMENSION STYLE MM ONLY	SCALE NTS	DESIGN UNITS METRIC	THIRD ANGLE PROJECTION
		mm	INCH																		
	4 PLACES	± ---	± ---																		
	3 PLACES	± ---	± ---																		
2 PLACES	± 0.2	± ---																			
1 PLACE	± ---	± ---																			
DESCRIPTION C4	DRAFT WHERE APPLICABLE MUST REMAIN WITHIN DIMENSIONS	DRAWN BY: KSEE CHECKED BY: KCLING APPROVED BY: PTLIM	DATE: 2003/11/14 DATE: 2003/12/15 DATE: 2003/12/15	TITLE CUSTOM HEADER 2MM SINGLE ROW HDR IN SMT WITH PEG, BREAKAWAY	MOLEX INCORPORATED	MATERIAL NO. SEE TABLE															
					DOCUMENT NO. SD-87858-001	SHEET NO. 2 OF 3															
			SIZE A3	THIS DRAWING CONTAINS INFORMATION THAT IS PROPRIETARY TO MOLEX INCORPORATED AND SHOULD NOT BE USED WITHOUT WRITTEN PERMISSION																	

PACKAGING TYPE	CKT	DIMENSION					PACKABLE QTY
		BoA	Ao	K2	F	W	
T1	2	5.00	8.50	4.40	7.50	16.00	1200
	4	9.00	8.50	4.40	11.50	16.00	1200
T2	2	11.40	5.00	4.20	11.50	24.00	2000

TYPE T1 PACKAGING
SOLDERTAIL ON RIGHT

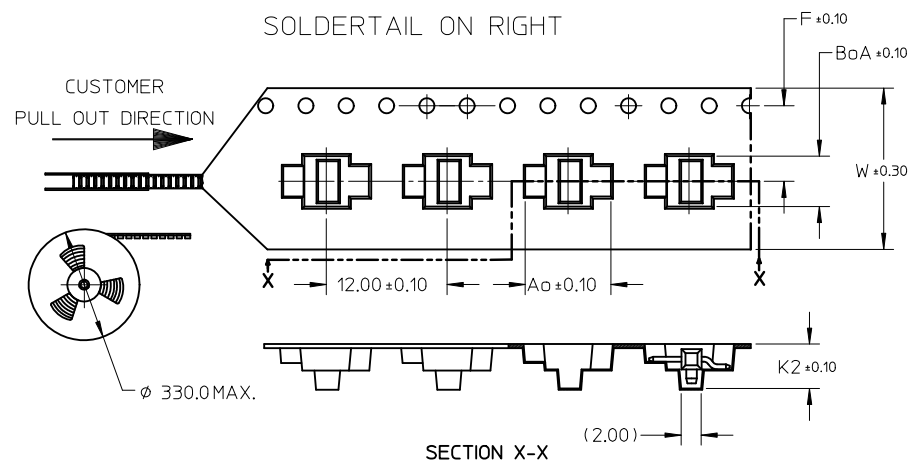

TYPE T2 PACKAGING
SOLDERTAIL ON LEFT

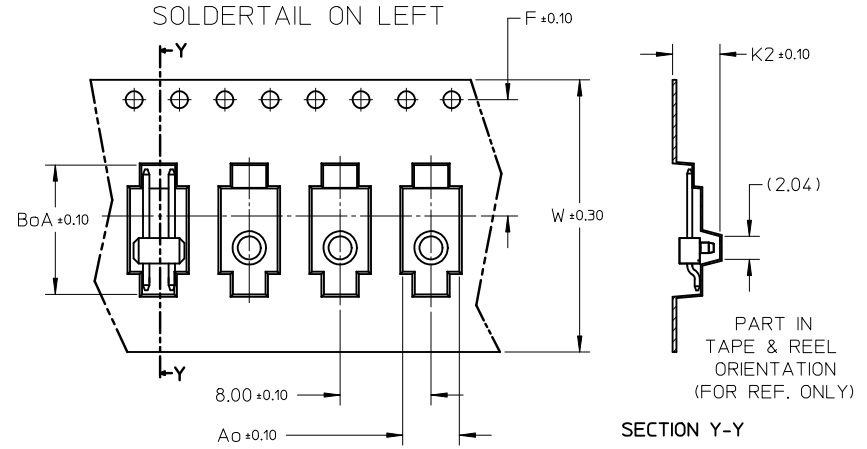

NOTES:

1. LEADER AND TRAILER TAPE

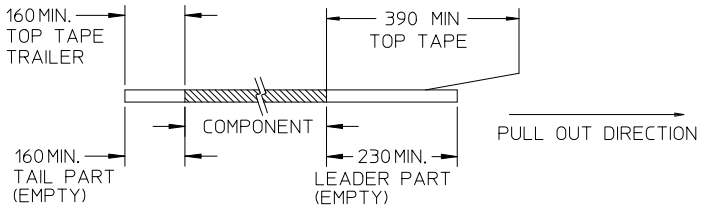

2. PEELING OFF FORCE OF THE TOP TAPE: 20-80gf.
(PEELING DIRECTION AS SHOWN IN FOLLOWING FIGURE)

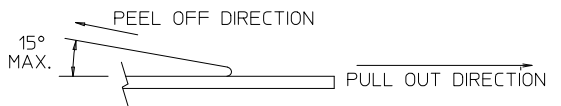

- 3. MATERIAL: BLACK P.S CONDUCTIVE, THICKNESS 0.40±0.10.
- 4. PACKAGING STANDARD IS AS PER EIA-481.
- 5. THE TAPE IS TREATED FOR ANTI-STATIC.

ADD P/N: 87858-0005	2010/11/18	DRWN:SKANG	2010/11/18
EC NO: S2011-0457	2010/11/29	CHKD:ATSEE	2010/11/29
	2010/12/01	APPR:MLONG	2010/12/01
C4	REV	DESCRIPTION	

QUALITY SYMBOLS	▽=0
	◻=0

GENERAL TOLERANCES (UNLESS SPECIFIED)	mm	INCH	
	4 PLACES	± ---	± ---
	3 PLACES	± ---	± ---
	2 PLACES	± 0.2	± ---
	1 PLACE	± ---	± ---
ANGULAR ± 3 °			
DRAFT WHERE APPLICABLE MUST REMAIN WITHIN DIMENSIONS			

DIMENSION STYLE		SCALE	DESIGN UNITS	THIRD ANGLE PROJECTION
MM ONLY		NTS	METRIC	
DRAWN BY	DATE	TITLE		
KSEE	2003/11/14	CUSTOM HEADER		
CHECKED BY	DATE	2MM SINGLE ROW HDR IN		
KCL ING	2003/12/15	SMT WITH PEG, BREAKAWAY		
APPROVED BY	DATE	MOLEX INCORPORATED		
PTL IM	2003/12/15	MOLEX INCORPORATED		
MATERIAL NO.	DOCUMENT NO.	SHEET NO.		
SEE TABLE	SD-87858-001	3 OF 3		