

PART NUMBER	REV	USED USED
466909-1	K	854040-3

TERMINAL NAME: CONTACT, ROUND WIRE					
PIN	RECEPT	VISIBLE	CRIMPING DATA		
LTR		PAD	CRIMP HEIGHT		WIRE SIZE
86557	86566	A	.028 ±.002	[0.71 ±0.05mm]	22
86599	88067	B	.025 ^{+0.001} / _{-.002}	[0.63 ^{+0.02} / _{-0.05} mm]	24 OR 26
		C	NOT		USED
		D	NOT		USED
		CRIMP	SIZE	TYPE	RANGE
		WIRE	.055 [1.4mm]	F	26-22
		INSUL	.062 [1.57mm]	0	.043-.054
WIRE STRIP LENGTH	TERM APPL SPEC	FEED	APPL INSTRUCTION	SET UP GAGE	LAYOUT
-	114-16003	.330	SEE CUSTOMER MANUAL	NONE	470

SIM TO HDM 466572

QTY	REV	REF	DESCRIPTION	ITEM NO
				70
				69
				68
				67
				66
				65
				64
				63
				62
				61
				60
				59
				58
				57
				56
				55
				54
				53
				52
				51
				50
				49
				48
				47
				46
				45
				44
				43
				42
				41
				40
				39
				38
				37
				36
				35
				34
				33
				32
				31
				30
				29
				28
				27
				26
				25
				24
				23
				22
				21
				20
				19
				18
				17
				16
				15
				14
				13
				12
				11
				10
				9
				8
				7
				6
				5
				4
				3
				2
				1

QTY	REV	REF	DESCRIPTION	ITEM NO
2	-	C	7-354779-2	PIN, WIRE DISC (.3350)D 129
2	-	C	6-354779-6	PIN, WIRE DISC (.3320)C 128
				127
				126
1	-	A	986950-1	WASHER, FLAT PRECISION 125
1	-	A	217238-3	DOCUMENTATION PACKAGE 124
				123
				122
				121
1	-	B	690701-2	PLATE, SERIAL NO. 120
2	-	A	21899-2	WASHER, FLAT (#10) S G ADJ BLK 119
				118
2	-	A	21024-5	WASHER, LOCK (#10) ADJ BLOCK 117
				116
				115
2	-	A	21024-2	WASHER, LOCK (#4) FRONT STP GUIDE 114
REF	-	A	21024-4	WASHER, LOCK (#8) FEED FINGER 113
2	-	A	21024-4	WASHER, LOCK (#8) DEP-HOLD 112
REF	-	A	21024-4	WASHER, LOCK (#8) STRIPPER 111
				110
				109
				108
				107
				106
				105
1	-	A	21009-2	SCR, SKT 5ET (1/4-20x.25 LW) RAM 103
				102
4	-	A	21017-2	SCR, DRIVE (#2x.19) ID PLATE 101
1	-	B	819347-1	PLATE, IDENTIFICATION 100
2	-	A	3-21002-0	SCR, BHC (10-32x.88) DRAG 99
1	-	A	22733-8	SCR, BHC (8-32x.38 LW) ANVIL 98
2	-	A	1-21002-6	SCR, BHC (6-32x.25) TERM HOLDER 97
1	-	A	3-21000-8	SCR, SHC (10-32x.88) MOUNTING 96
1	-	A	2-21002-7	SCR, BHC (10-32x.50) S6 ADJ BLK 95
4	-	A	2-21002-2	SCR, BHC (8-32x.50) SHEAR-TERM SUP 94
				93
				92
1	-	A	1-21002-7	SCR, SHC (6-32x.50) CAM 91
2	-	A	2-21000-7	SCR, SHC (8-32x.50) SCR BLK 90
				89
				88
2	-	A	3-21000-0	SCR, SHC (8-32x.81) DEP-HOLD DOWN 87
REF	-	A	2-22603-0	SCR, HEX HD (8-32x.31) FEED FINGER 86
2	-	A	1-21000-3	SCR, SHC (4-40x.25) F ST GUIDE 85
REF	-	A	22733-9	SCR, BHC (8-32x.50 SL) STRIPPER 84
				83
				82
1	-	A	3-22603-1	SCR, HEX (10-32x.38) S6 ADJ BL 81
				80
				79
				78
2	-	B	463310-6	BLADE, STRIPPING (#22) 77
				76
				75
1	-	A	690603-1	SPRING, ASSIST 74
1	-	A	23030-1	SCR, SKT CAP (6-32x.25) CP DSC 73
				72
				71

QTY	REV	REF	DESCRIPTION	ITEM NO
-1	U/M			

QTY	REV	REF	DESCRIPTION	ITEM NO
-1	U/M			

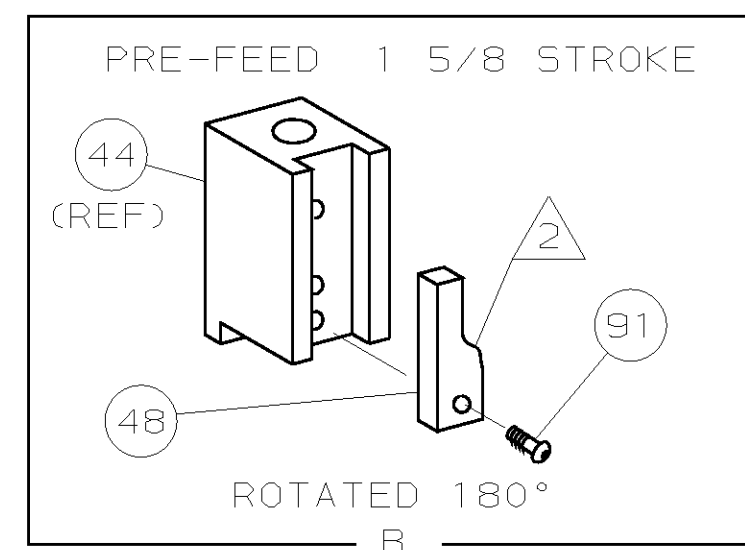
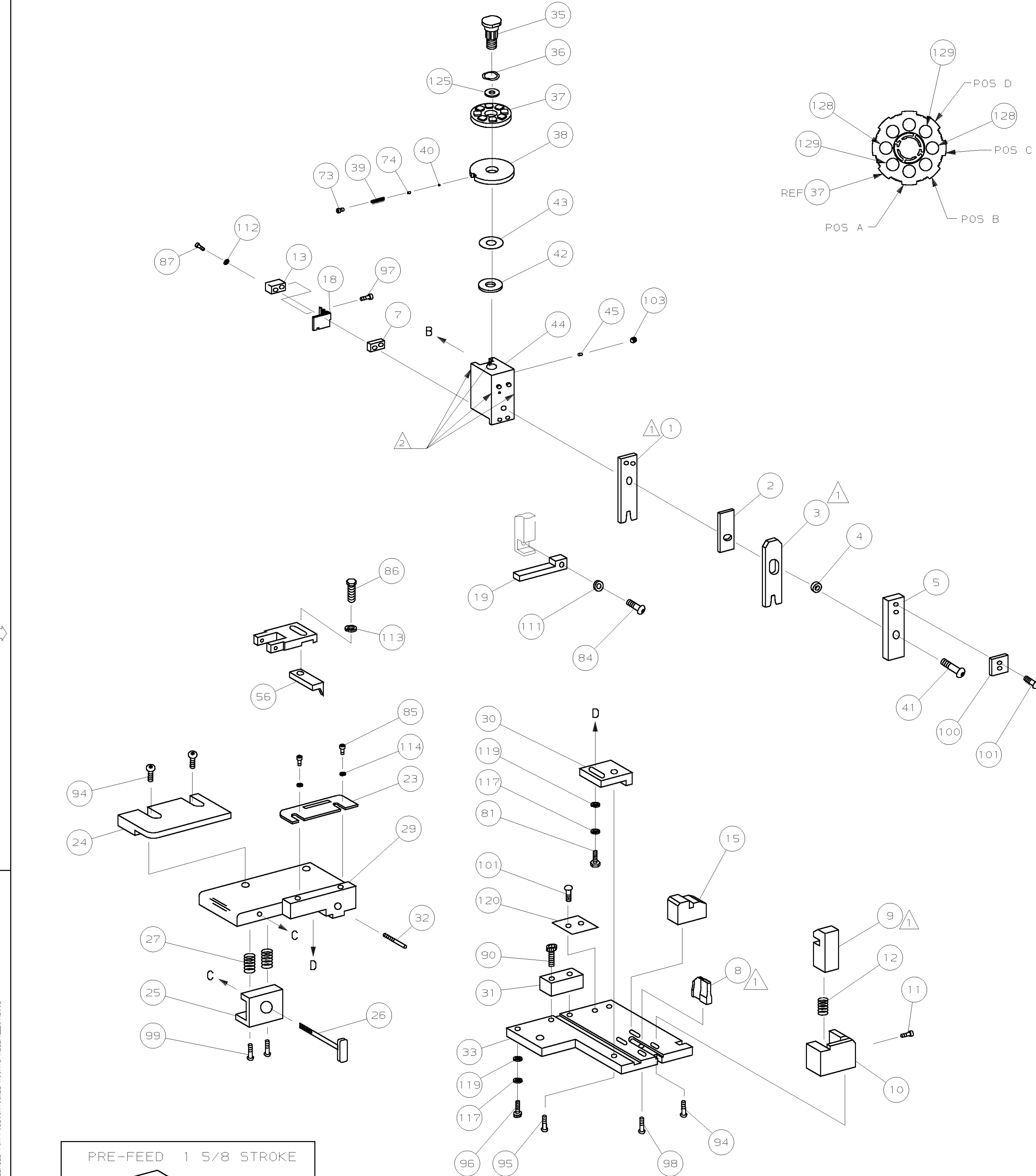

- 1 RECOMMENDED SPARE PARTS.
- 2 GREASE LIGHTLY.
- 3 ITEM NOT SHOWN
- 4 CUT TO LENGTH AT ASSEMBLY.
- 5 INSULATION CRIMP HEIGHT, .068 MAX.

DIMENSIONS IN INCHES. DO NOT SCALE PRINT.		MATERIAL		FINISH	
TOLERANCES UNLESS OTHERWISE SPECIFIED:		DR	11/29/95	APP	2-16-96
1 PLC DEC ±		D. SALTZER	T. ELBIN	AMP Incorporated	
2 PLC DEC ±		CHK 2-16-96	REL 2/29/96	Harrisburg, PA 17105-3608	
3 PLC DEC ±		C. ERISMAN	B. MORGAN		
4 PLC DEC ±					
ANGLES ±					
SURF TEXTURE: ✓					
REMOVE BURRS, BREAK SHARP EDGES R.015 MAX					
NAME		STRIPPER CRIMPER APPLICATOR		MACHINE REF	
SCALE		DWG NO 466909		SHEET 1 OF 1	
REV		K1		REV	

THIS DRAWING IS A CONTROLLED DOCUMENT.

THIS DRAWING IS UNCLASSIFIED - RELEASED FOR PUBLICATION. RELEASED FOR PUBLICATION. RIGHTS RESERVED 2002. AMP 1756 REV 3-92

466909