

THIS DRAWING IS A CONTROLLED DOCUMENT.

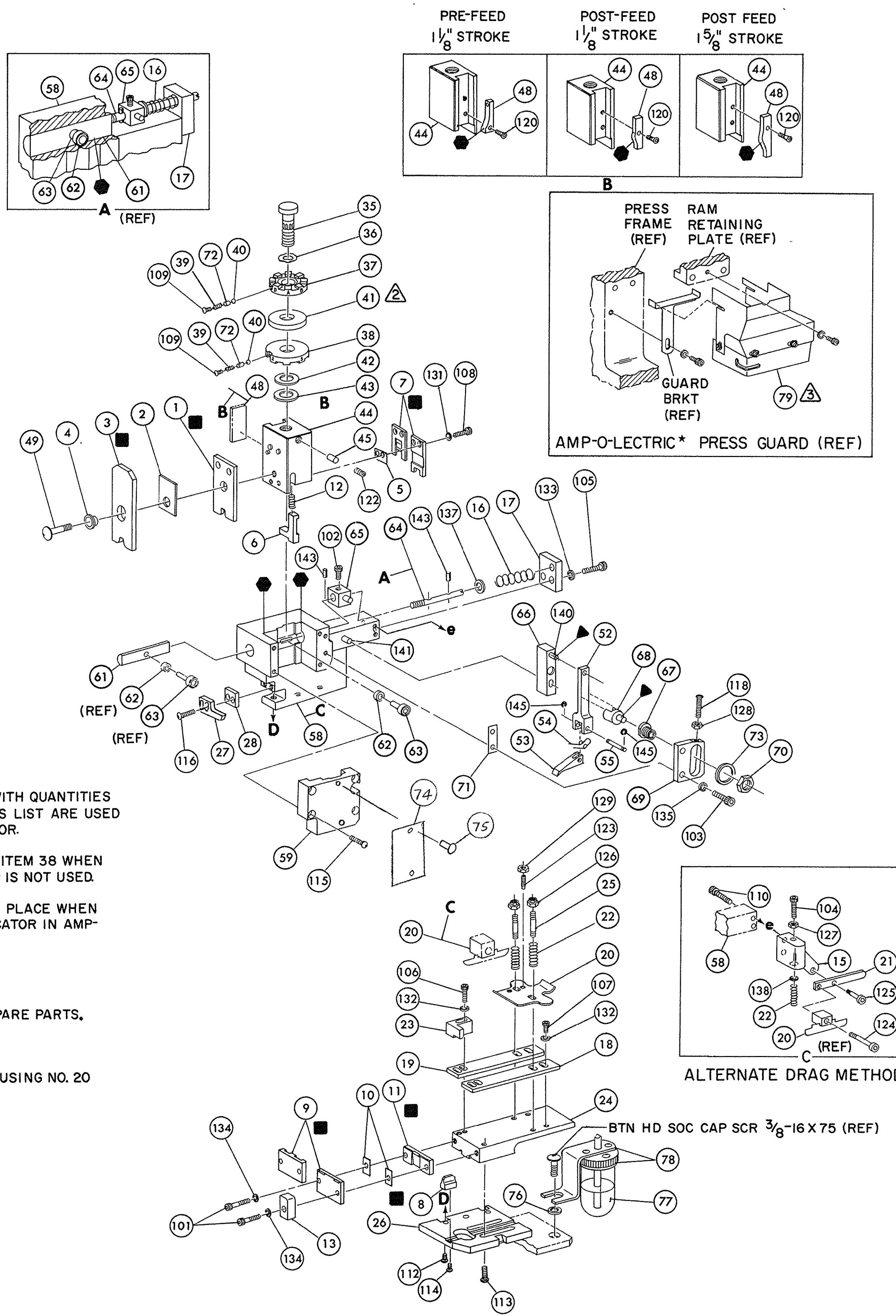

- NOTES:**
- 1. ONLY THE ITEMS WITH QUANTITIES SPECIFIED ON PARTS LIST ARE USED ON THIS APPLICATOR.
 - ▲ USED IN PLACE OF ITEM 38 WHEN INSULATION CRIMP IS NOT USED.
 - ▲ GUARD MUST BE IN PLACE WHEN OPERATING APPLICATOR IN AMP-O-LECTRIC PRESS.
- KEY:**
- RECOMMENDED SPARE PARTS.
 - ▲ LUBRICATE DAILY USING NO. 20 MACHINE OIL.
 - GREASE LIGHTLY.

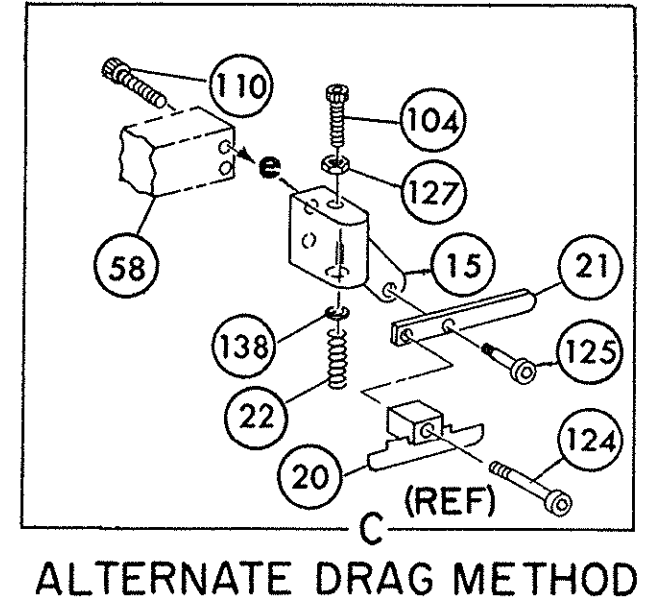

QTY	PART NO	DESCRIPTION	ITEM NO	QTY	PART NO	DESCRIPTION	ITEM NO
2	21045-3	RING, RETAINING 'C' (.187 DIA) FEED PIN	145	1	454220-1	CAP, RAM	59
2	5-21028-1	PIN, SLOT SPG (.12 DIA X .50) FD ADJ ROD	144	1	453736-1	HOUSING	58
1	1-21030-7	PIN, DOWEL (.187 DIA X 1.50) HOUSING	143				57
1	1-21030-1	PIN, DOWEL (.187 DIA X .50) LEVER	142				56
1	22260-5	WASHER, FLAT (NO 6) DRAG SPRING	141	1	240624-1	PIN, FEED FINGER	55
1	21899-4	WASHER, FLAT (5/16 DIA) SCR ADJ	140	1	691499-1	SPRING, FEED FINGER	54
2	21024-5	WASHER, LOCK (NO 10) FEED ADJ PLATE	139	1	240635-1	FINGER, FEED	53
2	21024-5	WASHER, LOCK (NO 10) SHEAR PLATES	138	1	240634-1	LEVER, TERMINAL	52
2	21024-5	WASHER, LOCK (NO 10) FEED ROD GUIDE	137				51
5	21024-4	WASHER, LOCK (NO 8) STRIP GUIDE	136				50
2	21024-4	WASHER, LOCK (NO 8) SHEAR BLADE	135	1	7-21002-9	BOLT, CRIMPER	49
2	21018-4	NUT, HEX MACH (4-40) DRAG	134	1	690501-4	CAM, POST FEED 1 5/8 STROKE	48
1	21068-5	NUT, HEX MACH (6-32) FD ADJ PLATE	133				47
1	21018-7	NUT, HEX MACH (10-32) DRAG SPRING	132				46
2	21022-2	NUT, HEX SELF-LKG (8-32) DRAG STUD	131	1	690191-1	PLUG, NYLON	45
1	5-21004-7	SCR, SKT HD SHLD (250 DIA X .25) DRAG ARM	130	1	455674-1	RAM	44
1	21004-5	SCR, SKT HD SHLD (250 DIA X 1.00) DRAG	129	1	690125-1	WASHER, LAMINATED	43
2	4-21078-8	SCR, SKT SET OVAL POINT (4-40 X .75) DRAG	128	1	690124-1	WASHER, RAM	42
1	22651-9	SCR, SKT SET (1/4-20 X 25) (LOC-WEL) RAM	127				41
1	1-21002-7	SCR, BTN HD SKT CAP (6-32 X .38) CAM	126	2	23241-6	BALL, STEEL	40
1	3-21064-2	SCR, RD HD MACH (6-32 X 1.50) FEED ADJ	125	2	690170-1	SPRING, COMPRESSION	39
2	2-21002-2	SCR, BTN HD SKT CAP (8-32 X .50) STRIPPER	124	1	690142-1	DISC, INSULATION	38
4	2-21002-9	SCR, BTN HD SKT CAP (10-32 X .75) HSG CAP	123	1	1-692155-3	DISC, WIRE	37
1	24073-2	SCR, BTN HD SKT CAP (8-32 X .38) (LOC-WEL) ANVIL	122	1	22480-5	WASHER, SPRING	36
4	3-21002-3	SCR, BTN HD SKT CAP (1/4-20 X .50) STR GDE PL	121	1	690212-1	POST, RAM	35
3	1-24073-9	SCR, BTN HD SKT CAP (1/4-20 X .75) BASE PL	120				34
1	2-21000-4	SCR, SKT HD CAP (6-32 X 1.00) DRAG ADAPTOR	119				33
2	3-23657-8	SCR, SKT HD CAP (6-32 X .25) (LOC-WEL) CP DISC	118				32
2	2-21000-9	SCR, SKT HD CAP (8-32 X .75) SHEAR BLADE	117				31
3	2-21000-6	SCR, SKT HD CAP (8-32 X .38) STRIP GUIDE	116				30
2	2-21000-9	SCR, SKT HD CAP (8-32 X .75) STRIP GUIDE	115				29
2	3-21000-7	SCR, SKT HD CAP (10-32 X .75) FD ROD GUIDE	114	1	3-690451-2	SPACER, STRIPPER	28
1	3-21000-9	SCR, SKT HD CAP (10-32 X 1.00) DRAG SPRING	113	1	240639-1	STRIPPER	27
2	3-21000-6	SCR, SKT HD CAP (10-32 X .62) FD ADJ PLATE	112	1	455676-1	PLATE, BASE	26
1	3-21000-4	SCR, SKT HD CAP (10-32 X .38) PIVOT BLK	111	2	22354-8	DRAG, STUD	25
2	3-21000-8	SCR, SKT HD CAP (10-32 X .88) SHEAR PLATE	110	1	455678-1	PLATE, STRIP GUIDE	24
REF	455745-1	GUARD, WINDOW	79		240825-1	PLATE, STRIP HOLD	23
1	465184-9	LUBRICATOR ASSY	78				22
1	455985-1	OIL, LUBRICATING	77				21
1	454406-1	SPACER, LUB BRACKET	76	1	240644-1	PLATE, REAR SHEAR	11
2	21017-2	SCR, DRIVE (#2 X .19) ID PLATE	75				10
1	461264-1	PLATE, IDENTIFICATION	74	1	690482-4	PLATE, FRONT SHEAR	9
1	458109-1	WASHER, FLAT (SPECIAL)	73	1	2-240693-3	ANVIL	8
2	690603-1	SPRING, ASSIST	72	1	690474-4	BLADE, SLUG	7
1	690517-1	SPACER	71				6
1	22594-8	NUT, HEX	70	1	5-240641-5	HOLD DOWN, TERMINAL	5
1	240628-1	PLATE, ADJ	69	1	238009-1	SPACER, SHEAR BLADE	4
1	240626-1	SHAFT, PIVOT	68	1	456134-6	SPACER, TUBULAR	3
1	240633-1	BUSHING	67	1	455888-5	CRIMPER, INSULATION	2
1	455680-1	LEVER, INTERMEDIATE	66	1	456408-6	CRIMPER, WIRE	1
1	240629-1	BLOCK, PIVOT	65				
1	240632-2	SCREW, ADJ	64				
1	240659-3	PIN, CAM ROLLER	63				
1	240658-1	CAM, ROLLER	62				
1	454398-1	ROD, FEED	61				

CRIMPING DATA		APPLICATOR WILL APPLY	
PAD LTR	CRIMP HEIGHT	WIRE SIZE	WIRE LENGTH
A	1.68	2.0	170030
B	1.55	1.75	
C	1.42	.85	
D	1.35	.5	
CRIMP	SIZE	TYPE	FEED
WIRE	.110	F	1.040
INSUL	.180	F	A1 8039
WIRE RANGE	18-14	INSULATION RANGE	.085-.135
PRESS NO			
REMARKS			
AMPOMATOR			

REMARKS	NO	REV
APPL USED ON MACHINE PART NO	MACH SERIAL NO	DISTRIBUTION
CUSTOMER NAME	APPL SERIAL NO	ORIGINAL
ADDRESS	PURCHASE ORDER	CUSTOMER COPY
CITY	ENG APP	FIELD ENG COPY

F ECR-06-006698
 E 0150-0849-00
 D 0150-8514-98
 C 0150-6777-96
 B REV PER EW R-5483
 A REV PER ECN R2859

SET UP GAGE 10-1
 458638-1 59
 DR 8-20-11 APP 12-27-79
 CHRG-117 REL 12/1/84
 NAME MINIATURE QUICK CHANGE APPLICATOR
 END FEED (.250 FASTON TAB)

AMP INCORPORATED
 Harrisburg, Pa.
 LOC A NO 466249-1 REV F
 00773 CUSTOMER AND ASSEMBLY DRAWING