

**SCHEMATIC**

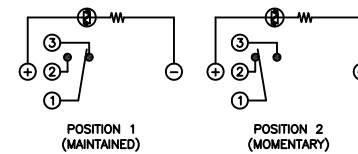

**SPECIFICATIONS**

**FUNCTION:**  
1P2T ON-(ON)

**RATING:**  
2A 48VDC

**ILLUMINATION VOLTAGE:**  
12V 20mA

**CONTACT RESISTANCE:**  
Initial: 50mΩ Max. at 1A 12VDC

**INSULATION RESISTANCE:**  
1,000MΩ Min. at 500VDC

**DIELECTRIC STRENGTH:**  
2,000VAC Min. for 1 Minute

**ELECTRICAL LIFE:**  
50,000 Cycles

**MECHANICAL LIFE:**  
1,000,000 Cycles

**TEMPERATURE:**  
Operating: -20°C to 70°C

**INGRESS PROTECTION:**  
IP65

**APPROVALS:**  
**RoHS**  
COMPLIANT

A

A

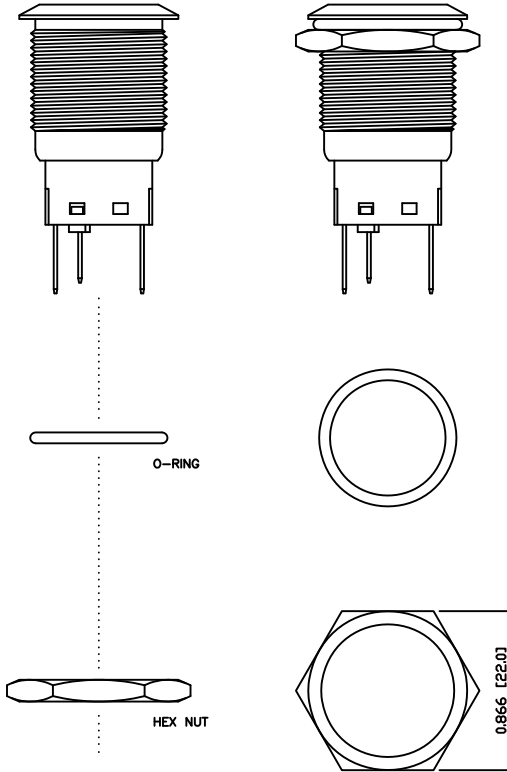
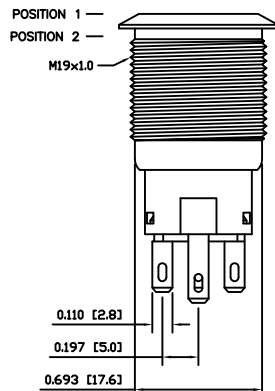
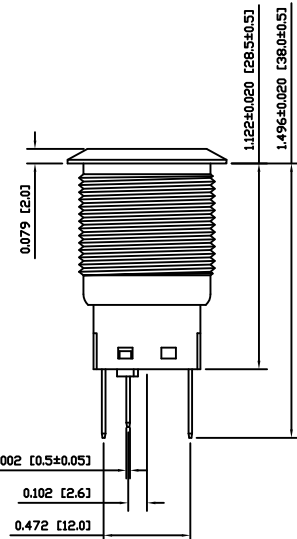

**MATERIALS**

**BUSHING:**  
Stainless Steel (304)

**BASE:**  
Polycarbonate (PC)  
Polybutylene Terephthalate (PBT), UL94 V-2

**ACTUATOR:**  
Stainless Steel (304)  
Polycarbonate (PC)

**HARDWARE:**  
Nickel Plated Brass (H59)

**SEALING:**  
Silicone Rubber

**INNER ASSEMBLY:**  
Polyoxymethylene (POM)  
Phosphor Bronze

**SPRING:**  
Spring Steel

**CONTACTS:**  
Silver/Cadmium Oxide (AgCdO)

**TERMINALS:**  
Silver Plated Brass (H62)  
Silver Plated Phosphor Bronze

**O-RING:**  
Silicone Rubber

**COLORS AND FINISH**

**BEZEL:**  
Stainless Steel  
Machine Finish

**ACTUATOR:**  
Stainless Steel  
Machine Finish

**ILLUMINATION:**  
Green (Forward)  
Blue (Reverse)

**MARKING:**  
None

B

B

C

C

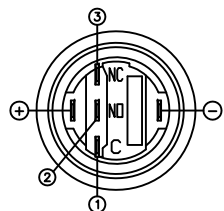

**SUGGESTED PANEL CUTOUT**

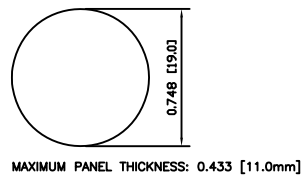

**EXPLODED VIEW**

**ASSEMBLED VIEW**

D

D

|                |      |          |     |
|----------------|------|----------|-----|
| BODY           | A    | 09/07/24 | CAB |
| COLORS         | A    | 09/07/24 | CAB |
| MATERIALS      | B    | 09/10/16 | CAB |
| SPECIFICATIONS | A    | 09/07/27 | CAB |
| REFERENCE      | REV. | DATE     | BY  |

THE INFORMATION CONTAINED IN THIS DOCUMENT IS PROPRIETARY TO E-SWITCH AND IS NOT TO BE COPIED OR TRANSFERRED

|      |                 |       |          |          |
|------|-----------------|-------|----------|----------|
| A    | INITIAL RELEASE | 19419 | 10/11/09 | CAB      |
| REV. | DESCRIPTION     | PCR   | DATE     | DRAWN BY |

|                      |            |
|----------------------|------------|
| DIMENSIONS           |            |
| INCHES [MILLIMETERS] |            |
| GENERAL TOLERANCES   |            |
| ±0.008 [±0.2] / ±1'  |            |
| SCALE                | PROJECTION |
| DRAWING NOT TO SCALE | 1st Angle  |

|                      |                  |          |
|----------------------|------------------|----------|
|                      |                  |          |
| <b>PV4F2BOSS-3N4</b> |                  |          |
| ITEM NUMBER          | DATE             | REVISION |
| 52-PV4F2BOSS3N4      | NOVEMBER 9, 2010 | A        |