

DRAWING REVISIONS			
REV	DOCUMENT	APP	DATE
A	DO 06-1033	AKC	6-15-06

SIZE	A	B	C	D	E	F	G	H	J	K	PART NO.
9	1.209	.984	.642	.500	.313	.592	.749	.314	.360	.187	702 12 09 010
15	1.536	1.312	.970	.500	.313	.918	.749	.314	.360	.187	702 12 15 010
25	2.079	1.852	1.510	.500	.313	1.462	.749	.314	.360	.187	702 12 25 010
37	2.724	2.500	2.158	.500	.313	2.114	.749	.314	.360	.187	702 12 37 010

THRU HOLE
2X Ø 0.138
Ø 0.160

ENGAGING SIDE

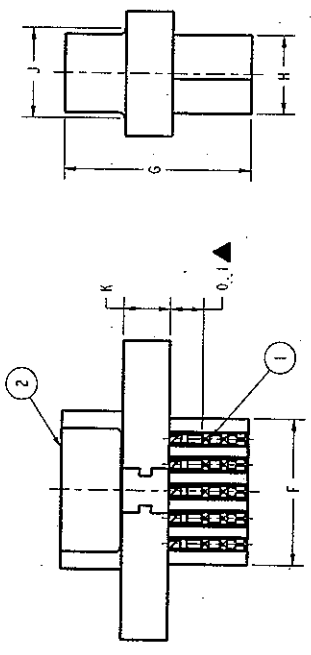

- NOTES:
- UNLESS OTHERWISE SPECIFIED, ALL DIMENSIONS ARE REFERENCE ONLY.
 - SMALLEST UNIT PACKAGE MUST BE MARKED PER EM-25 FIGURE 1, PARAGRAPH 7 AND FIGURE 3.
 - INK MARK PER EM-9 THE "CINCH" LOGO PER EM-40, CINCH CATALOG NUMBER PER BOX AND "RoHS" AND DATE CODE PER EM-4-4, 1716 HIGH CHARACTERS. METHOD 19 OF EM-9 IS PREFERRED METHOD.
 - PARTS TO BE BULK PACKED 1000 PCS PER PACKAGE
 - RoHS NON COMPLIANT PART NO.'S.: 232 34 09 000, 232 34 15 000, 232 34 25 000 AND 232 34 37 000.

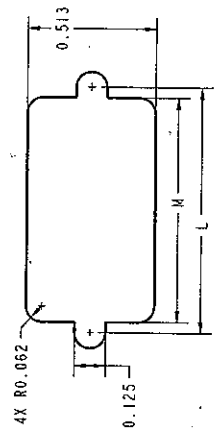

RECOMMENDED PANEL CUT-OUT

SIZE	L	H
9	.984	.900
15	1.312	1.202
25	1.852	1.743
37	2.500	2.391

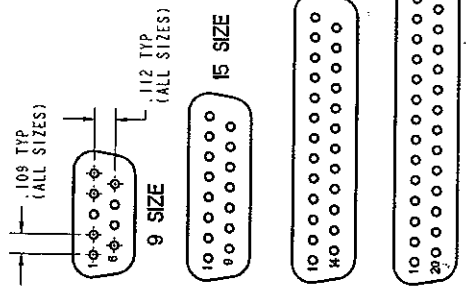

CONTACT ARRANGEMENT - AS VIEWED FROM ENGAGING SIDE

RoHS COMPLIANT

ENGLISH INCHES		PRO/E	
DO NOT SCALE DRAWING	UNLESS OTHERWISE SPECIFIED, ALL DIMENSIONS ARE IN INCHES	DESIGNED BY	JIMENEZ
FILED PATH	FILED DATE	DESIGNED ENGINEER	A. BALI
DATE	DATE	DESIGNED ENGINEERING MGR.	A. BALI
1/27/06	1/27/06	MGY. ENGINEERING	M. CRUZ
5/7/06	5/7/06	QUALITY ASSURANCE	R. QUIROZ
7/17/06	7/17/06	DATE OF THIS DOCUMENT'S RELEASE	7/17/06
5/5/06	5/5/06	DATE OF THE INFORMATION CONTAINED HEREIN	5/5/06
5/5/06	5/5/06	DATE OF THIS DOCUMENT'S RELEASE	5/5/06

Cinch		PRO/E	
D-SUB ALL PLASTIC IDC T-SERIES SOCKET ASSEMBLY		TITLE	D-SUB ALL PLASTIC IDC T-SERIES SOCKET ASSEMBLY
CONTRACT TYPE NUMBER		DATE	1/27/06
PROJECT NUMBER		MATERIAL	
CI4690-6		MATERIAL SPEC NUMBER	FRESH
702 12 09 010		DATE FILE NUMBER	7/17/06
71785 B		DATE OF THIS INFORMATION CONTAINED HEREIN	5/5/06
2:1		DATE OF THIS DOCUMENT'S RELEASE	5/5/06