

**DO NOT SCALE**

DIMENSIONS IN mm

**METRIC**

THIRD ANGLE  
PROJECTION

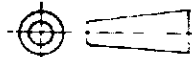

REVISIONS

LTR	DESCRIPTION	DATE	DWN	APVD
A1	REV PER ECO-09-022178	17DEC09	KK	AEG

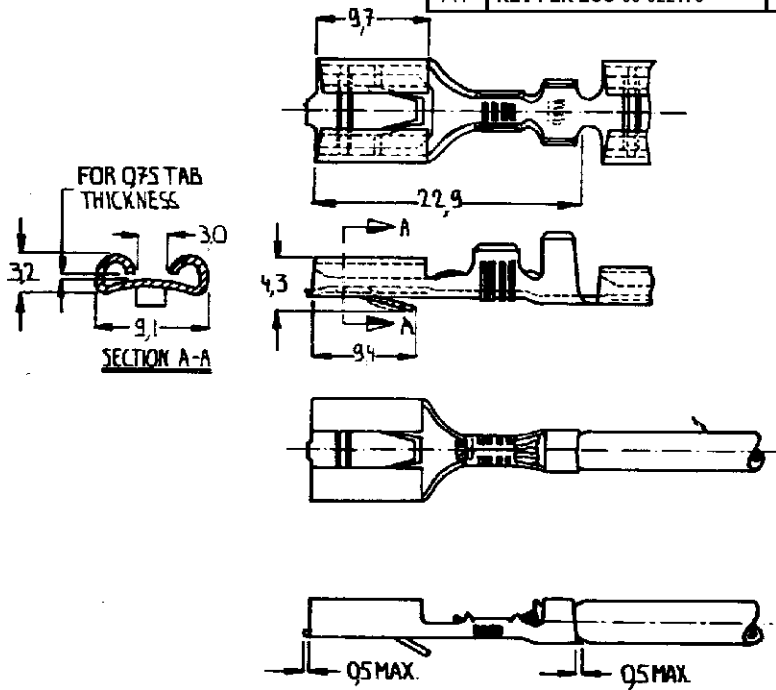

NOTE: 1. FOR USE ON STANDARD AND MINIATURE APPLICATORS.

2. REELED WITH PAPER COVER

3. OBSOLETE PARTS: OBSOLETE CIS STREAMLINING PER D.RENAUD/D.SINISI

OBSOLETE 3	FINISH	MATERIAL	PART NUMBER
	SILVERPLATING	BRASS	<del>160863-6</del>
SILVERPLATING	PHOSPHOR BRONZE	-5	
TINPLATING	BRASS	-4	
UNPLATED	BRASS	-3	
TINPLATING	PHOSPHOR BRONZE	-2	
UNPLATED	PHOSPHOR BRONZE	160863-1	

**CUSTOMER  
DRAWING**

FOR REFERENCE ONLY  
WILL NOT BE UPDATED

**AMP**

AMP-HOLLAND B V  
s-Hertogenbosch The Netherlands

THIS DRAWING IS UNPUBLISHED | RELEASED FOR PUBLICATION | 19

COPYRIGHT © BY AMP-HOLLAND B V  
ALL INTERNATIONAL RIGHTS RESERVED  
AMP PRODUCTS MAY BE COVERED BY U.S. AND FOREIGN PATENTS AND/OR PATENTS PENDING

DR <i>[Signature]</i> 29.9.84	WIRE RANGE 1.0-2.5 mm <sup>2</sup>	NAME 80mm SERIES FASTIN-FASTON RECEPTACLE	REV. DATE D M Y
CHK <i>[Signature]</i> 20.3.84	INSUL RANGE 2.1-3.1 DIA.		1 1 1
APP <i>[Signature]</i> 21.9.84	SIZE A4	SHEET 1 OF 1	REV. LTR A1
		DRAWING NO <b>C-160863-E</b>	