

THIS DRAWING IS UNPUBLISHED. RELEASED FOR PUBLICATION ,19 .
 © COPYRIGHT 19 BY AMP INCORPORATED. ALL INTERNATIONAL RIGHTS RESERVED.

LOC	DIST	P	F	REVISIONS			
ZONE	LTR	DESCRIPTION	DATE	APPD			
AF	50			H	REV PER 0G3A-0677-02	12NOV02	JR/ND

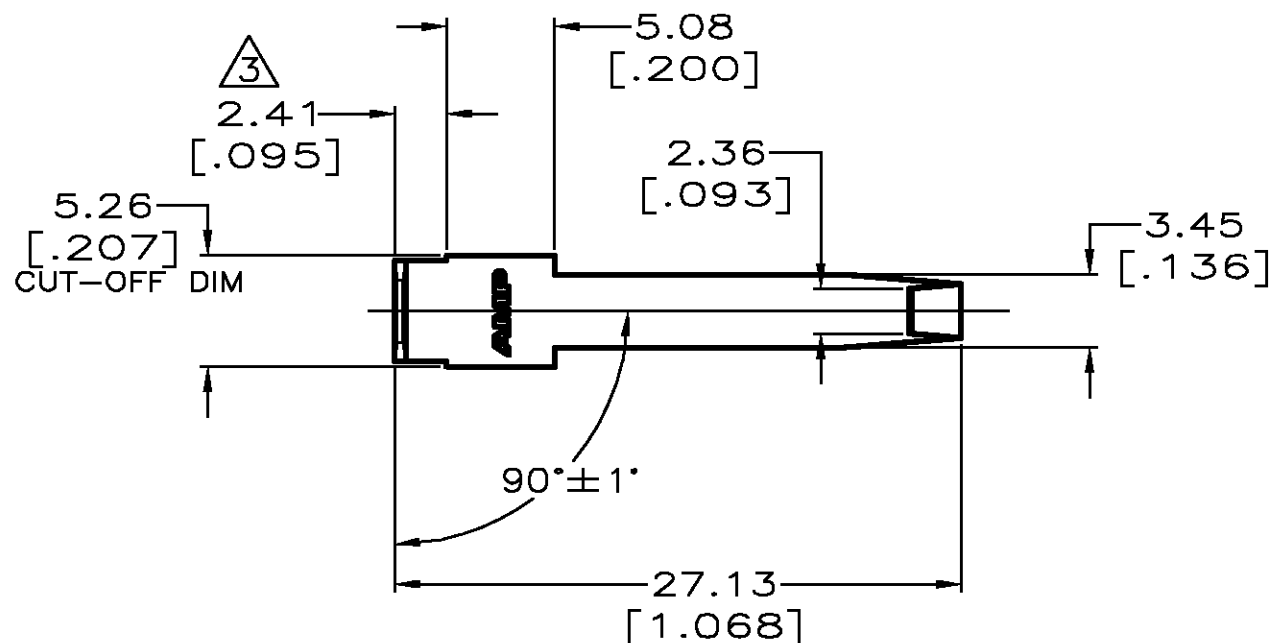

- 1 SUPPLIED IN LOOSE PIECE
- 2 0.41 [.016] THK 1/4 HARD S.STEEL WITH 0.102 [.004] THK COPPER CLAD, THIS SIDE ONLY.
- 3 DIM APPLIES AT TANGENT OF RADIUS AT BASE.
- 4 CLEANING PROCESS NOT INCLUDED.
- 5 0.51 [.020] THK 1/4 HARD S.STEEL
- 6 PRELIMINARY - NOT FOR PRODUCTION.

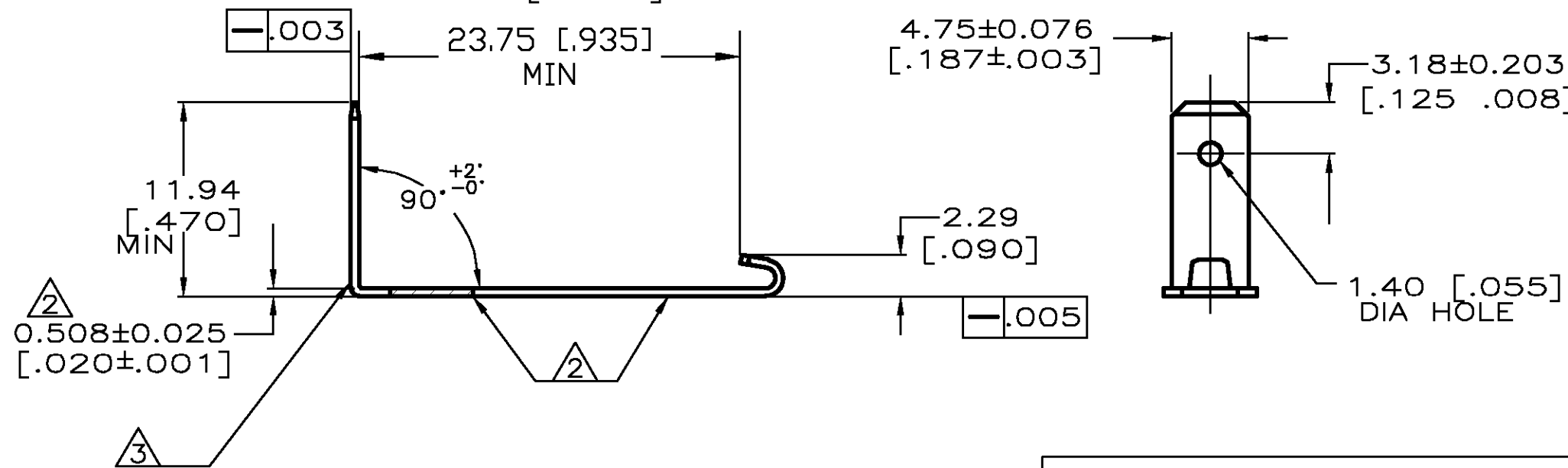

FINISH	MATERIAL	PART NO
-	5 63953-3	6 63953-3
4	2 63953-2	6 63953-2
-	2 63953-1	

DO NOT SCALE PRINT. UNLESS SPECIFIED	DR 11/14/97 JR RUTH
DIMENSIONS IN mm [INCHES]	CHK 11/14/97 MS FEHER
TOLERANCES ON:	APPD 11/14/97 P DESANTIS
2 PLC DEC ± 0.25 [.010]	APPD 11/14/97 D BRATINA
3 PLC DEC ± -	PRODUCT SPEC -
ANGLES ± 1'	APPLICATION SPEC -
MATERIAL SEE TABLE	WEIGHT -
FINISH SEE TABLE	

AMP AMP Incorporated Harrisburg, PA 17105-3608		
NAME TAB, SPECIAL, 4.75 [.187] SERIES		
SIZE B	CAGE CODE 00779	DRAWING NO C-63953
SCALE 3:1	SHEET 1 OF 1	

THIS DRAWING IS A CONTROLLED DOCUMENT FOR AMP INCORPORATED. IT IS SUBJECT TO CHANGE AND THE CONTROLLING ENGINEERING ORGANIZATION SHOULD BE CONTACTED FOR THE LATEST REVISION.