

THIS DOCUMENT IS UNCLASSIFIED EXCEPT WHERE SHOWN OTHERWISE. IT IS SUBJECT TO CHANGE AND THE CONTROLLING ENGINEERING INFORMATION SHOULD BE CONTACTED FOR THE LATEST REVISION.

NO. 687987-1

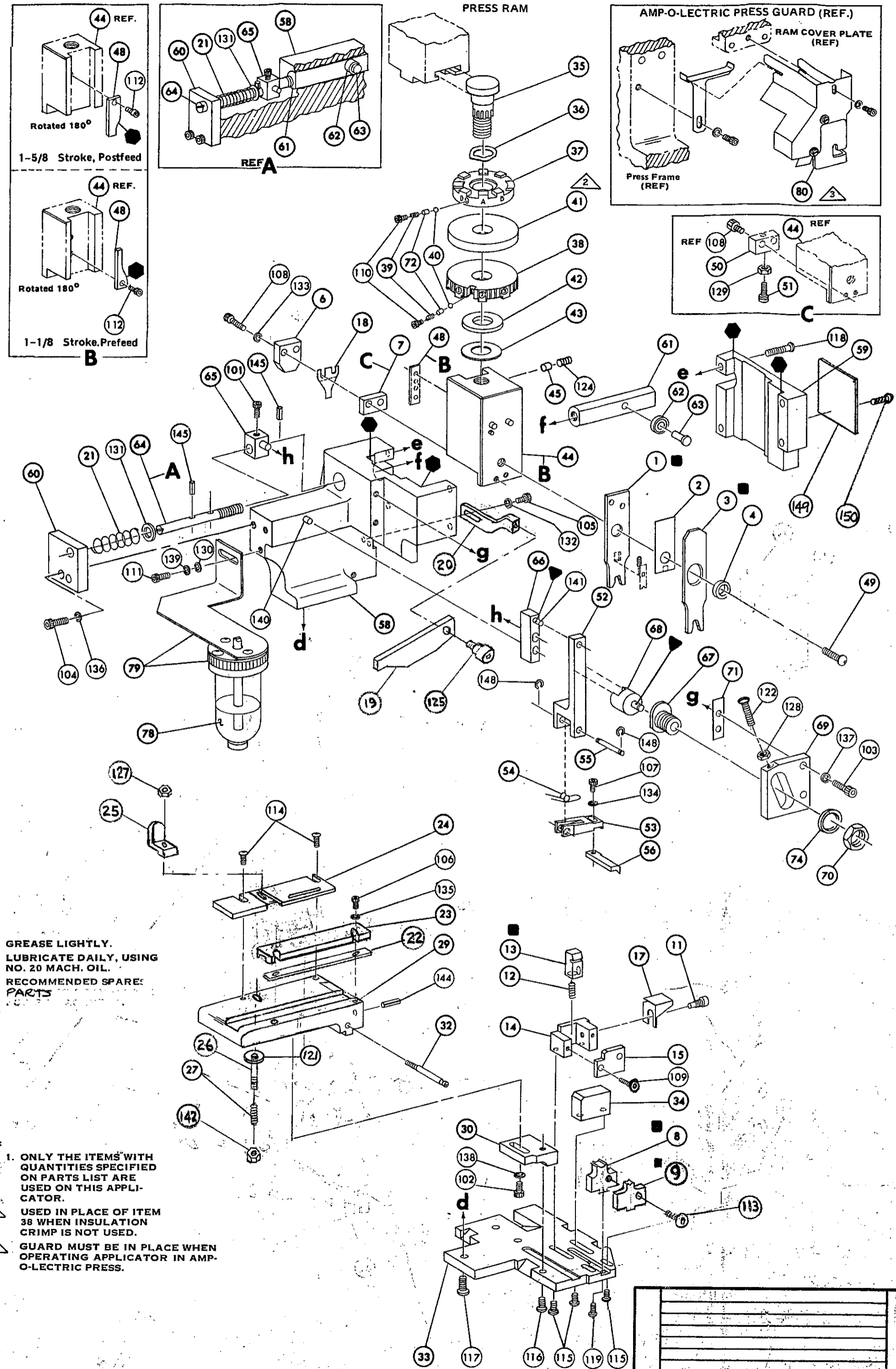

KEY:
● GREASE LIGHTLY.
▲ LUBRICATE DAILY, USING NO. 20 MACH. OIL.
■ RECOMMENDED SPARE PARTS

NOTES:
1. ONLY THE ITEMS WITH QUANTITIES SPECIFIED ON PARTS LIST ARE USED ON THIS APPLICATOR.
▲ USED IN PLACE OF ITEM 38 WHEN INSULATION CRIMP IS NOT USED.
▲ GUARD MUST BE IN PLACE WHEN OPERATING APPLICATOR IN AMP-O-LECTRIC PRESS.

REQ.	PART NO.	DESCRIPTION	NO.	REQ.	PART NO.	DESCRIPTION	NO.
			162	1	690517-1	SPACER	71
			161	1	22594-8	NUT, HEX	70
			160	1	240628-1	PLATE, ADJUSTMENT	69
			159	1	240626-1	SHAFT, PIVOT	68
			158	1	240633-1	BUSHING	67
			157	1	455680-1	LEVER, INTERMEDIATE	66
			156	1	240629-1	BLOCK, PIVOT	65
			155	1	240632-2	SCREW, ADJUSTMENT, FEED ROD	64
			154	1	240659-3	PIN, CAM ROLLER	63
			153	1	240658-1	ROLLER, CAM	62
			152	1	454398-2	ROD, FEED	61
			151	1	454178-1	GUIDE, FEED ROD	60
			150	1	454220-1	CAP, HOUSING	59
			149	1	454485-1	HOUSING	58
			148				57
			147	1	694433-7	PAWL, FEED	56
			146	1	240624-1	PIN, FEED FINGER	55
			145	1	691499-1	SPRING, FEED FINGER	54
			144	1	690541-1	FINGER, FEED	53
			143	1	455679-1	LEVER, TERMINAL FEED ARM	52
			142			BUMPER, HOLDDOWN	51
			141			SPACER, TONKER	50
			140	1	7-21002-9	BOLT, CRIMPER (MOD)	49
			139	1	690602-5	CAM PRE FEED STROKE 1 1/8	48
			138				47
			137				46
			136	1	690191-1	PLUG, NYLON	45
			135	1	455673-1	RAM	44
			134	1	690125-1	WASHER, LAMINATED	43
			133	1	690124-3	WASHER, RAM	42
			132			DISC, SPACER	41
			131	2	23241-6	BALL, STEEL	40
			130	2	690170-1	SPRING, COMPRESSION	39
			129	1	690142-1	DISC, INSULATION	38
			128	1	3-690692-7	DISC, WIRE	37
			127	1	22480-5	WASHER, SPRING	36
			126	1	690212-1	POST, RAM	35
			125			SUPPORT, TERMINAL	34
			124	1	455675-1	PLATE, BASE	33
			123	1	690432-3	SCREW, ADJUSTMENT	32
			122				31
			121	1	455689-1	BLOCK, STRIP GUIDE ADJ	30
			120	1	460042-1	PLATE, STRIP GUIDE	29
			119			SPACER, F. SHEAR DEPRESSOR	28
			118	1	2-22281-3	SPRING, DRAG	27
			117	1	22359-8	DRAG STUD	26
			116	1	387650-5	DRAG, STOCK	25
			115	1	460021-1	GUIDE, STRIP REAR	24
			114	1	460095-1	GUIDE, STRIP FRONT	23
			113	1	460019-1	SPACER, FRONT STRIP GUIDE	22
			112	1	4-22284-9	SPRING, FEED RETURN	21
			111	1	458950-1	BRACKET, STRIPPER	20
			110	1	458949-1	STRIPPER	19
			109			HOLDER, TERMINAL	18
			108			GUARD, CHIP REAR	17
			107			GUARD, CHIP FRONT	16
			106	1	690464-3	PLATE, SHEAR REAR	15
			105	1	690462-3	HOLDER, SHEAR REAR	14
			104	1	690463-1	SHEAR, FLOAT REAR	13
			103	1	5-22280-0	SPRING, SHEAR	12
			102	1	690461-1	STOP, SHEAR	11
			101			HOLDER, SHEAR FRONT	10
			80	1	454766-1	ANVIL - INSULATION	9
			79	1	459163-2	ANVIL - WIRE	8
			78	1	2-240641-7	SPACER, DEPRESSOR REAR	7
			77	1	690468-1	DEPRESSOR, SHEAR REAR	6
			76			DEPRESSOR, SHEAR FRONT	5
			75	1	238009-1	SPACER, TUBULAR, INS, CRIMPER	4
			74	1	454765-7	CRIMPER, INSULATION	3
			73			SPACER, CRIMPER	2
			72	1	454763-2	CRIMPER, WIRE	1

CRIMPING DATA	THIS APPLICATOR WILL APPLY				
PAD LETTER	CRIMP HEIGHT	WIRE SIZE	WIRE STRIP LENGTH	NO. PIDS	205 PIDS
A	.095	PIDG 22-18		350871	60816-
B	.075	PG			60817-
C	NOT USED				640173
D	NOT USED				350730
CRIMP WIRE	SIZE	TYPE	FEED	USED ON	
		COMB.	.650	MACH NO. 565435-5	187PG
INSULATION RANGE	WIRE RANGE	APPLICATOR INSTRUCTION	AT 8040	*350688	61516-
.135 MAX.	22-18				187 PIDG
REMARKS	AMP-O-LECTRIC PRE-FEED				
	▲ USE 12 DIA 50/50 SOLDER TO CHECK CRIMP HEIGHTS.				
	* WIRE RANGE 22-16 INS. 150 MAX.				
SET UP PAGE	LAYOUT NO.	678	AMP INCORPORATED HARRISBURG, PENNA.		
458637-1	NO.	678	HARRISBURG, PENNA.		
DRAWN	APPROVED	01-10-77	REV. NAME		
R. BENNETT			A C 687987-1		
CHECKED	11-12-73		NO. REV.		
I.V. MILLER			A C 687987-1		
SCALE	NAME	APPLICATOR MINIATURE QUICK CHANGE			
		HD SIDE-FEED (187 & 205 PG FASTON RECEPTABLE)			

LTR	REVISION RECORD	ECN	DATE	LTR	REVISION RECORD	ECN	DATE