

ITEM	QTY	PART NUMBER	DESCRIPTION
1	1	F040009	D16OAR11
2	1	F050405	50-004-05 28V INCANDESCENT
3	1	F052101	50-001-01 CONCAVE BLUE, OPAQUE

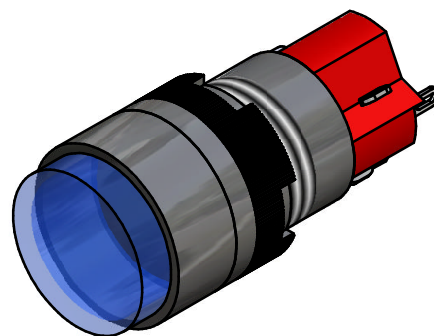

PANEL MOUNTING

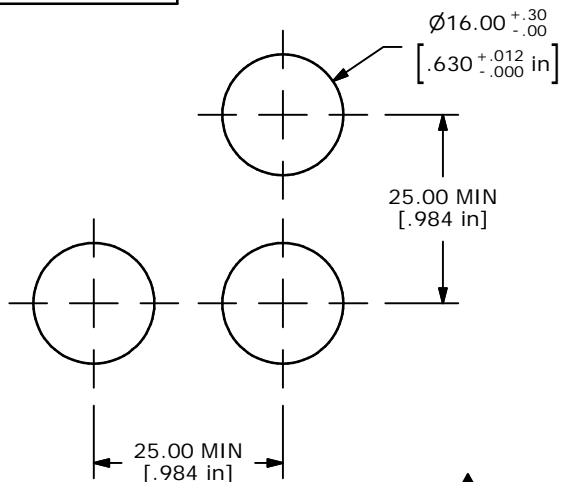
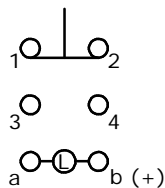

CONTACT CONFIGURATION

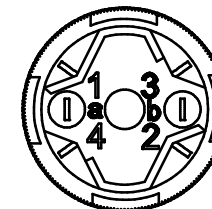
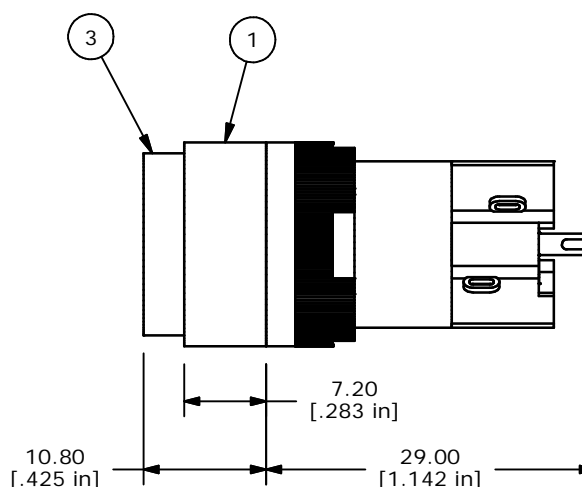
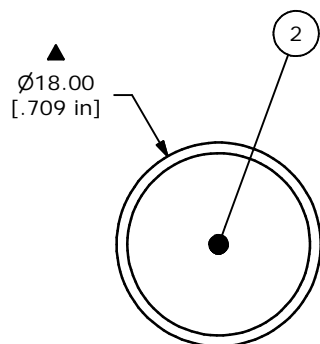

NOTE:

1. ALL DIMENSIONS IN MM [INCH]
2. GENERAL TOLERANCE: X.X=±0.4
X.XX=±0.25
3. TERMINAL NUMBERS FOR REF ONLY
4. MECHANICAL LIFE: 2,000,000 OPERATIONS
5. INSULATION RESISTANCE: 1,000 MILLI-OHM MIN.
6. OPERATING TEMP.: -25°C to 55°C
- ▲ 7. LAMP VOLTAGE: 28V AC/DC INCANDESCENT
8. ▲ DENOTES CRITICAL PARAMETER.

E-SWITCH®

REV	PCR NO	DESCRIPTION	DATE	BY
B	14359	CHANGE PART NUMBER FOR ITEM #3	9/29/04	AR
A	14327	RELEASED FOR PRODUCTION	9/17/04	AR

TITLE D16OAR11CBLU				
SCALE	DATE	DR	DWG	REV
2:1	9/17/04	AR	XF0605P	B

THE INFORMATION CONTAINED IN THIS DOCUMENT IS PROPRIETARY TO E-SWITCH AND IS NOT TO BE COPIED OR TRANSFERRED